



Patubig, Marilao, Bulacan



[bm.aluminum.inc@gmail.com](mailto:bm.aluminum.inc@gmail.com)



BM Aluminum & uPVC



+639677406336



044 248 0088

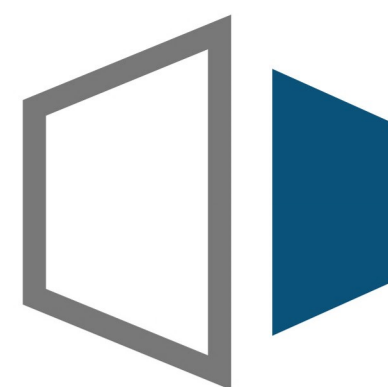

**BM** Aluminum  
and uPVC

Your partner in Aluminum and  
uPVC Window and Door System

Doors | Windows | Shower Enclosure | Balustrade



# Enjoy the beautiful home quality life

quality and enjoyment

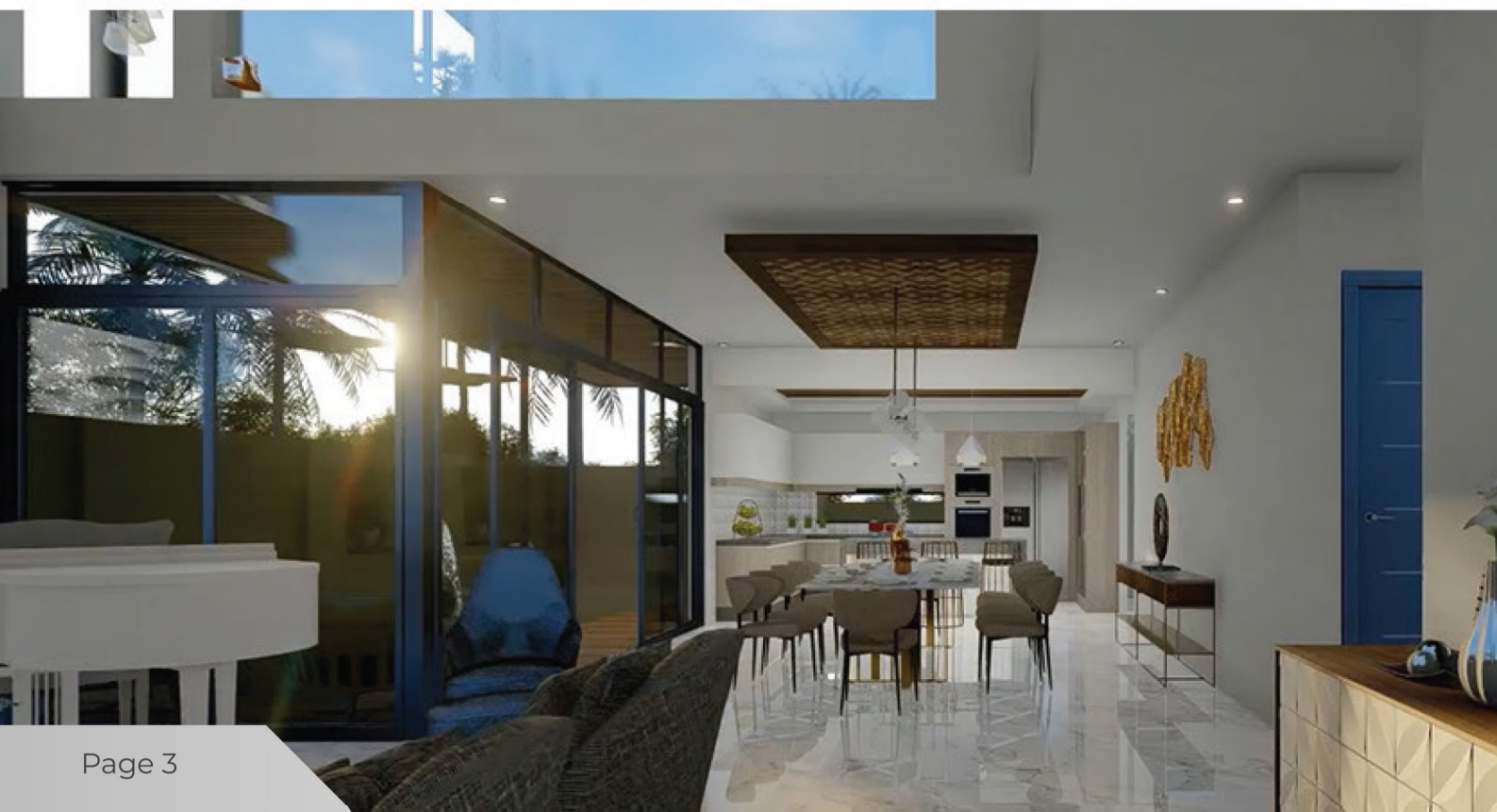

# BM ALUMINUM AND UPVC, INC

“Your Partner in Aluminum and uPVC Window & Door System”

At BM Aluminum and uPVC, we are at the forefront of aluminum and uPVC fabrication, delivering precision engineering and innovation that spans industries. With a commitment to excellence and a persistent pursuit of quality, we have established ourselves as a leading force in the aluminum and uPVC manufacturing sector.

BM Aluminum and uPVC has developed into a dynamic and forward-thinking organization dedicated to meeting the unique needs of our clients. We have developed a personalized aluminum and uPVC solutions, consistently exceeding expectations in terms of both design and performance.

## EXPERTISE:

- Our team of highly skilled engineers, craftsmen, and technicians are the heart of our operations. Their expertise, combined with state-of-the-art technology and facilities, empowers us to produce aluminum and uPVC products of exceptional quality. From custom extrusions to precision machining, our capabilities are vast, catering to diverse industries.

## CORE VALUES:

- **Quality** -Our unwavering commitment to quality assurance ensures that every product leaving our facility is of the highest standard.
- **Innovation** -We thrive on innovation, constantly pushing the boundaries of what's possible in aluminum and uPVC.
- **Customer-Centric** -Our clients are at the center of everything we do. We listen, adapt, and deliver solutions that meet their unique requirements.
- **Sustainability** -We embrace eco-friendly practices, striving to minimize our environmental footprint through responsible manufacturing.



## VISION:

To be the premier choice for aluminum and uPVC fabrication globally, recognized for excellence in quality, innovation, and sustainability.

## MISSION:

To empower our clients with cutting-edge aluminum and uPVC solutions that drive their success while contributing positively to society and the environment.

*Join us on a journey of excellence in aluminum and uPVC fabrication. At BM Aluminum and uPVC, we turn your aluminum and uPVC window and door dreams into reality.*



# Contents

<b>60</b> Series Aluminum Casement Window .....	<b>11</b>
<b>70</b> Series Thermal Break Aluminum Window .....	<b>17</b>
<b>K80</b> Series Thermal Break Aluminum Window .....	<b>23</b>
<b>96</b> Series Aluminum Sliding Door .....	<b>39</b>
<b>130</b> Series Aluminum Sliding Door .....	<b>45</b>
<b>146</b> Series Thermal Break Aluminum Lifting Sliding Door .....	<b>51</b>
<b>75</b> Series Aluminum Folding Door .....	<b>59</b>
<b>68</b> Series Thermal Break Aluminum Folding Door .....	<b>63</b>
<b>120</b> Series Thermal Break Aluminum Sliding Window with Net .....	<b>67</b>
<b>120</b> Series Aluminum Sliding Window with Net .....	<b>69</b>
<b>110</b> Series Thermal Break Aluminum Casement Window with Net .....	<b>75</b>
<b>50</b> Series Aluminum Casement Door .....	<b>81</b>
<b>16</b> Series Narrow Frame Aluminum Casement Door .....	<b>87</b>
<b>18</b> Series Narrow Frame Aluminum Casement Door .....	<b>91</b>
<b>125</b> Series Aluminum Sunroom European-Style .....	<b>95</b>
<b>120</b> Series Aluminum Sunroom with light .....	<b>99</b>
<b>120</b> Series Aluminum Sunroom European-Style .....	<b>101</b>

# GENERAL COLOR



Red Sandalwood



Yellow Pear



Yellow Rosewood

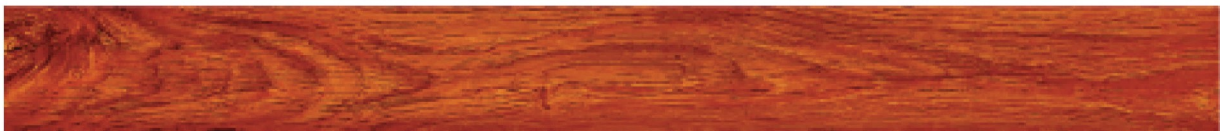

Golden Oak



White Oak

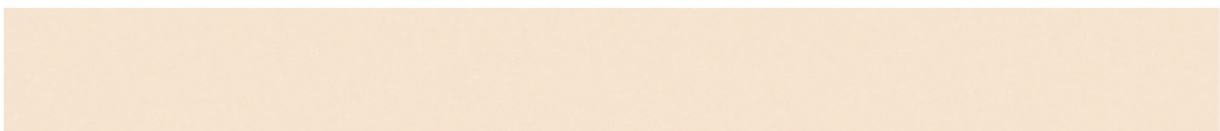

Fluorocarbon Champagne



Plain White



Matte Gray

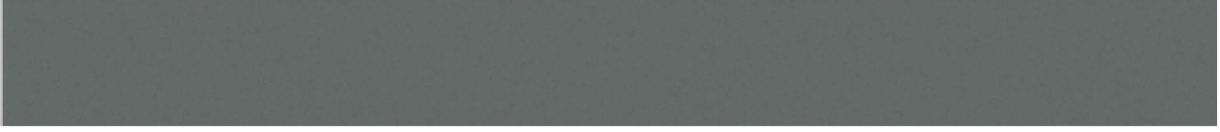

Imported Fluorocarbon Dark Gray



Imported Fluorocarbon Flash Gray

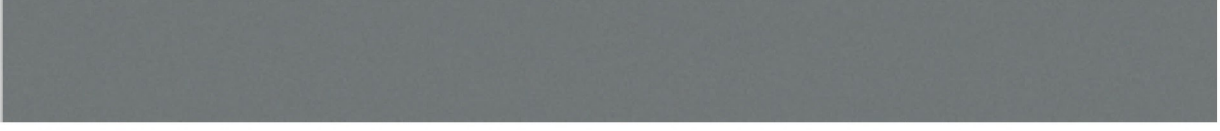

Metal Gray



Light Matte Gray

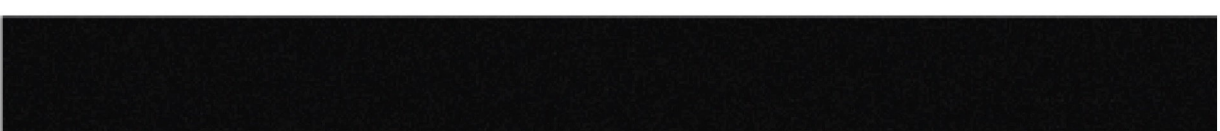

Matte Black

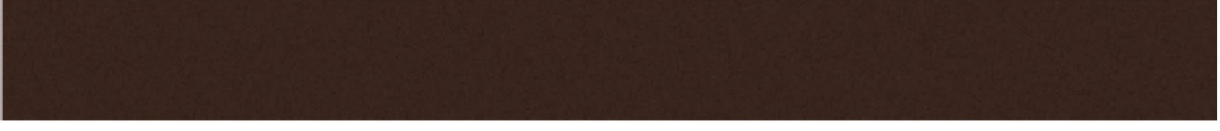

Matte Coffee



Fiction Stay

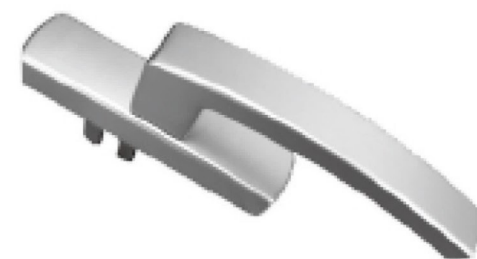

Handle



Drive rod - lock seat - lock point  
- connector



Transmission Box



Wind Bracing



Lock Cylinder



Lock Cylinder Cover



Hinge

# 60 SERIES ALUMINUM CASEMENT WINDOW

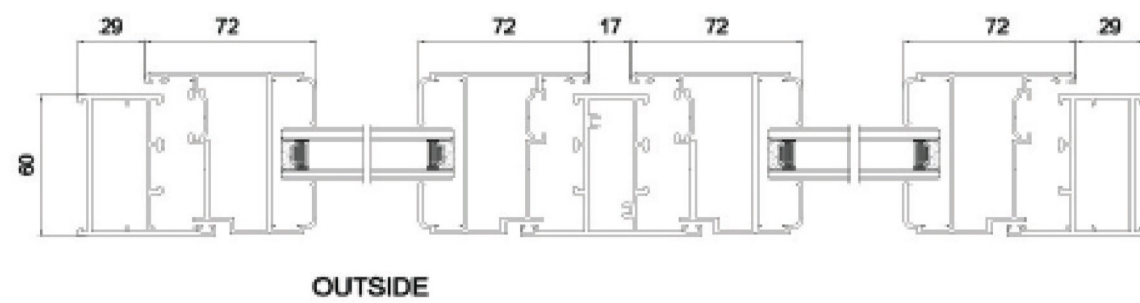
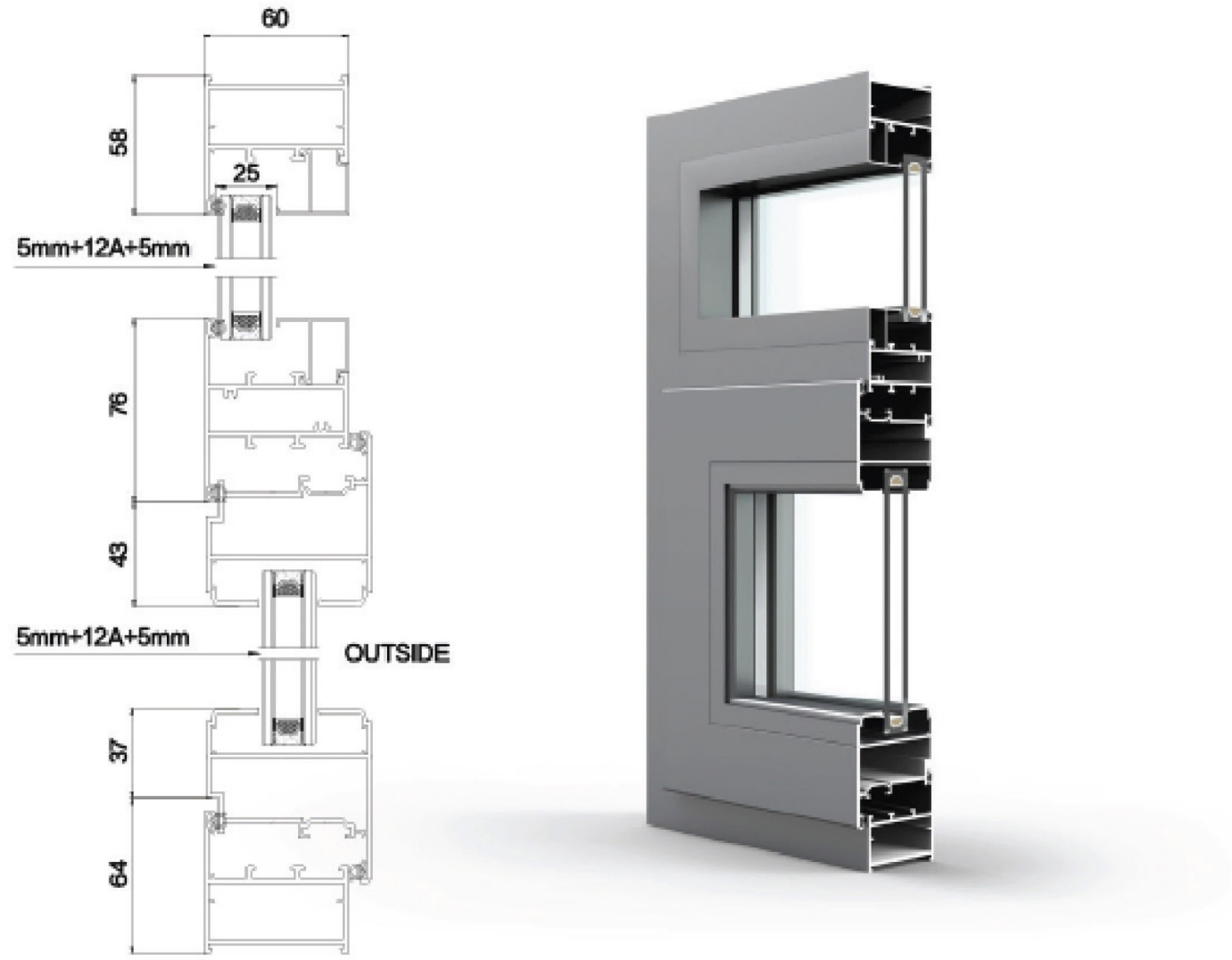

A good product must not only withstand the test of fashion changes, but a good design must also be able to insight into people's spiritual means, and maximize practical functionality and decoration. The exquisite design language is extracted from the line of doors and windows and transformed into the beauty of details.





# PRODUCT FEATURES

The design enables the window sash to open horizontally or indined to the room to open a certain angle for ventilation

---

**60** SERIES  
ALUMINUM CASEMENT WINDOW

---





Fiction Stay



Lock Cylinder



Drive rod - lock seat - lock point  
- connector

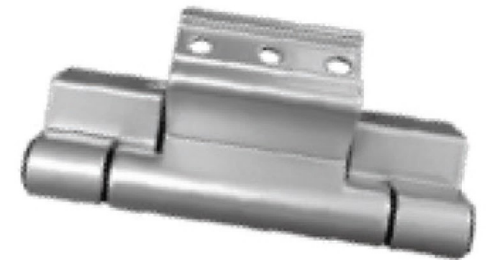

Hinge



Wind Bracing



Transmission Box



Lock Cylinder Cover



Door Handle

# 70 SERIES THERMAL BREAK ALUMINUM WINDOW

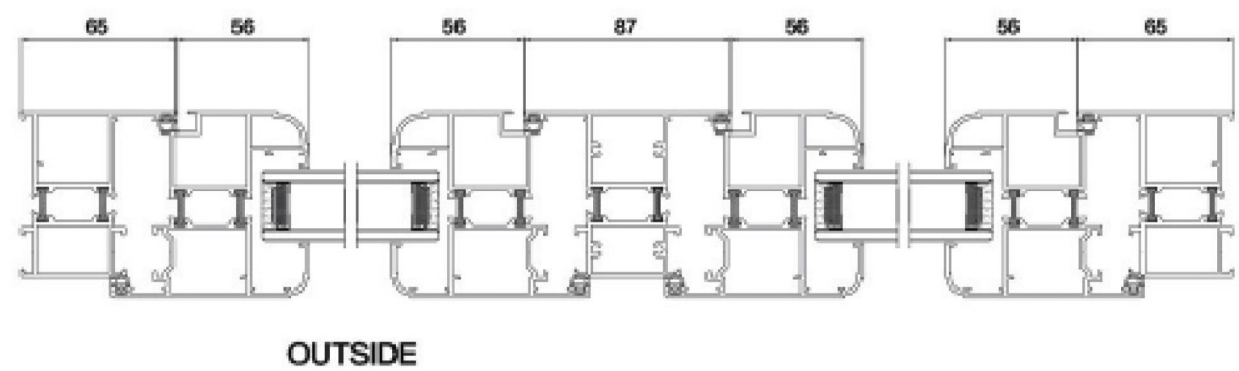
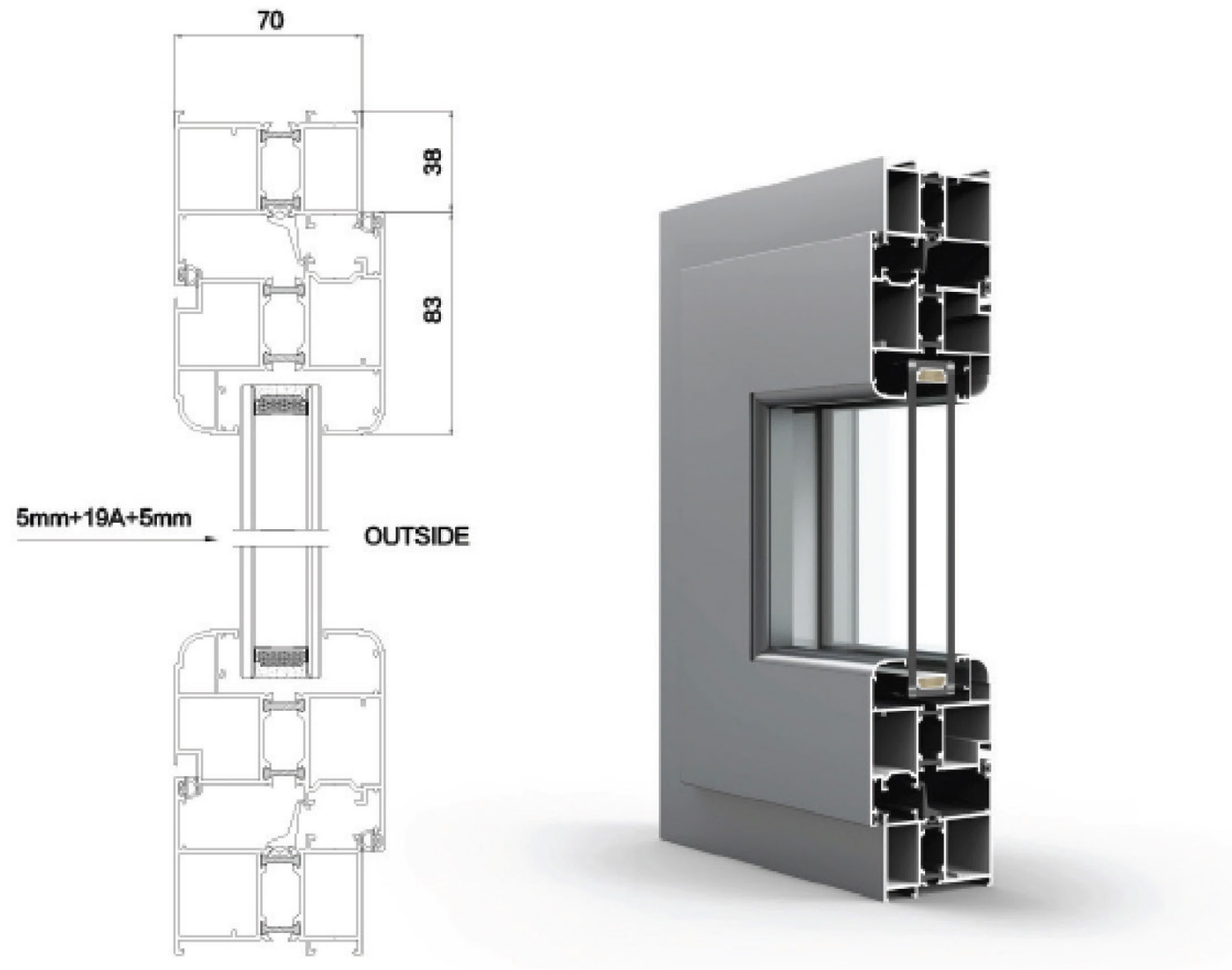

HIGH-END SYSTEM  
DOORS AND WINDOWS



Good doors and windows will bring a good life experience. Wanja's doors and windows adopt advanced design technology. Exquisite workmanship, high quality. Behind all this is the original spirit of pursuing beauty and excellence.

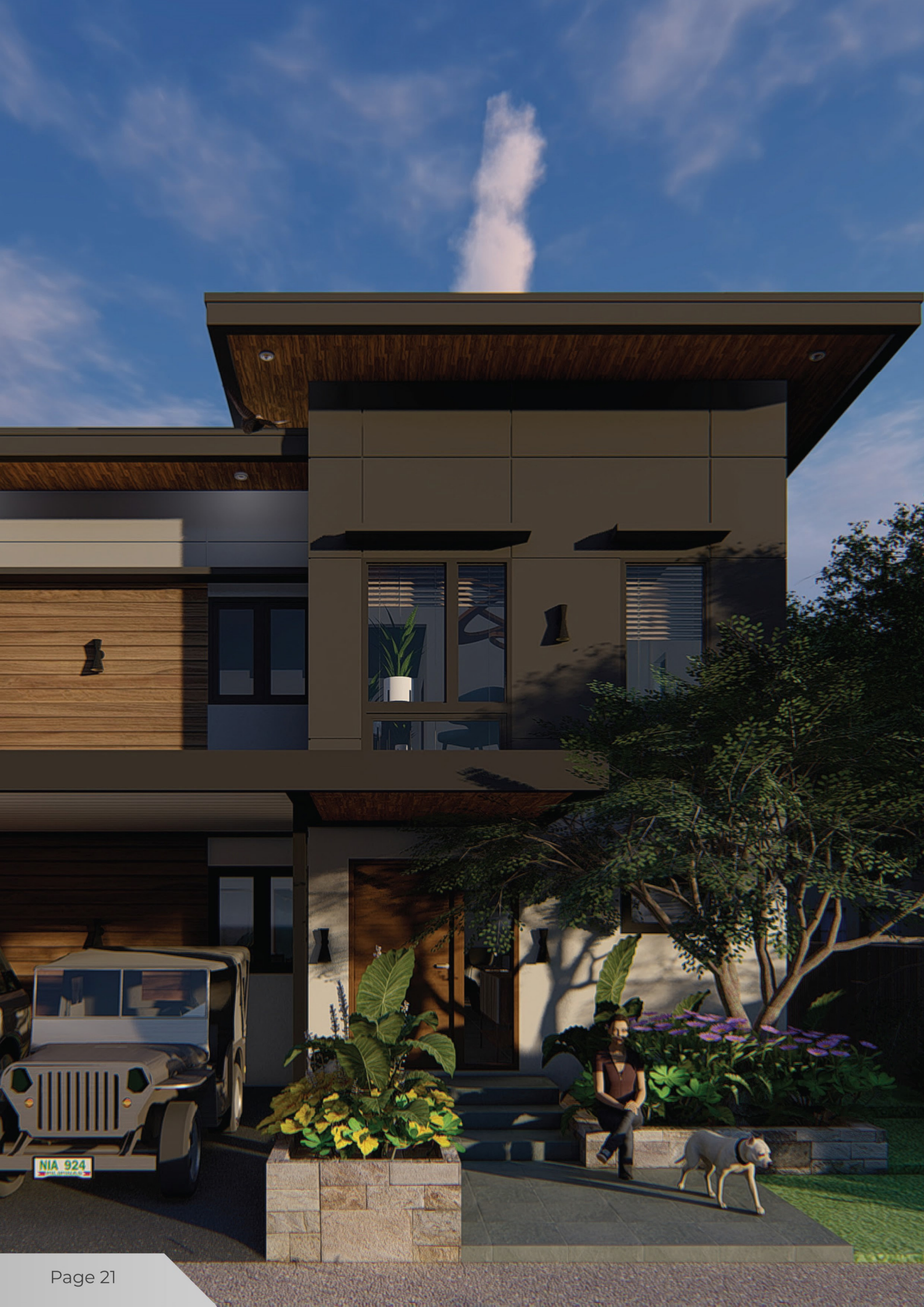

# 70 SERIES THERMAL BREAK ALUMINUM WINDOW

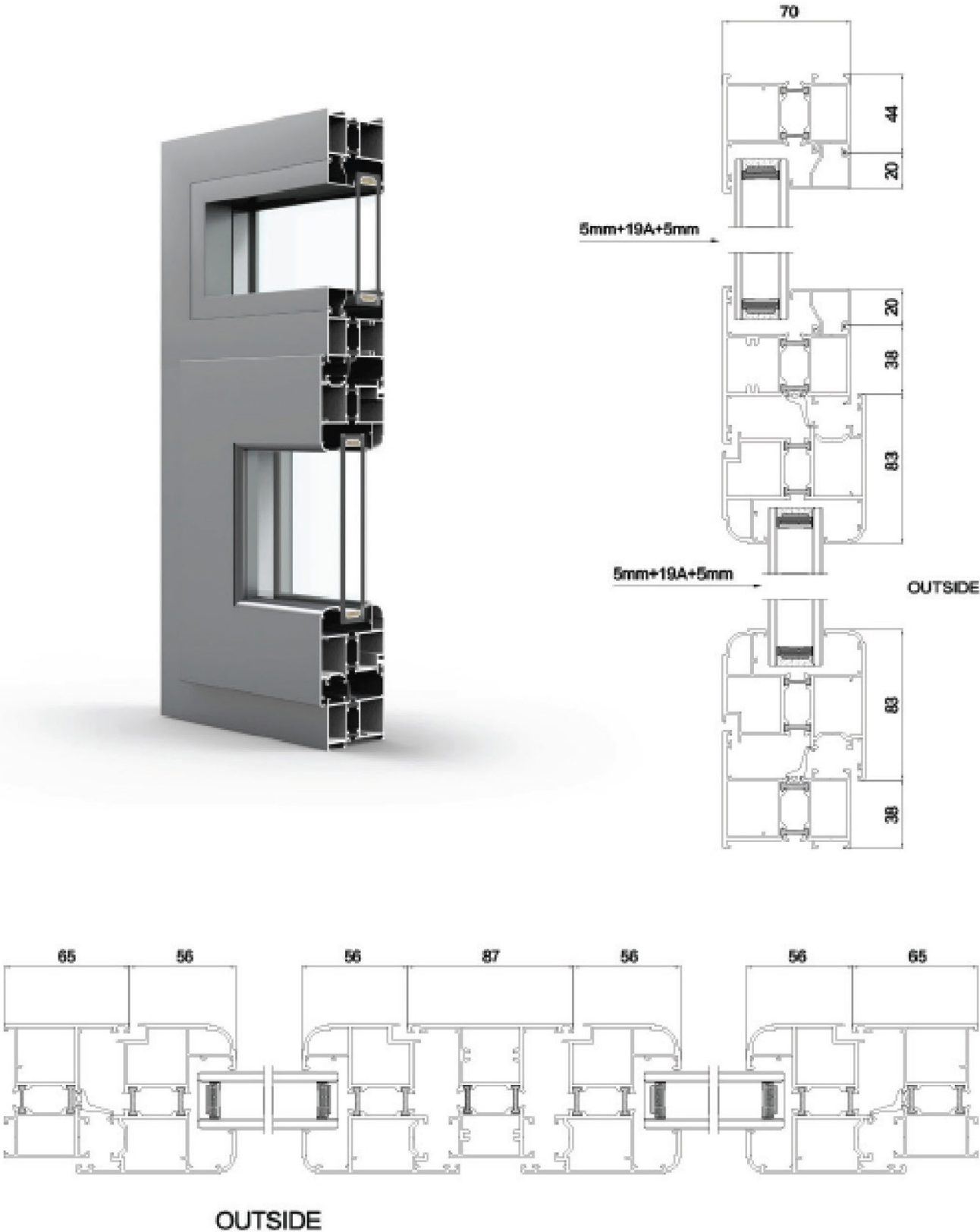



Fiction Stay



Hinge



Drive rod - lock seat - lock block



Lock Body



Anti falling Chain

# K80 SERIES THERMAL BREAK ALUMINUM WINDOW

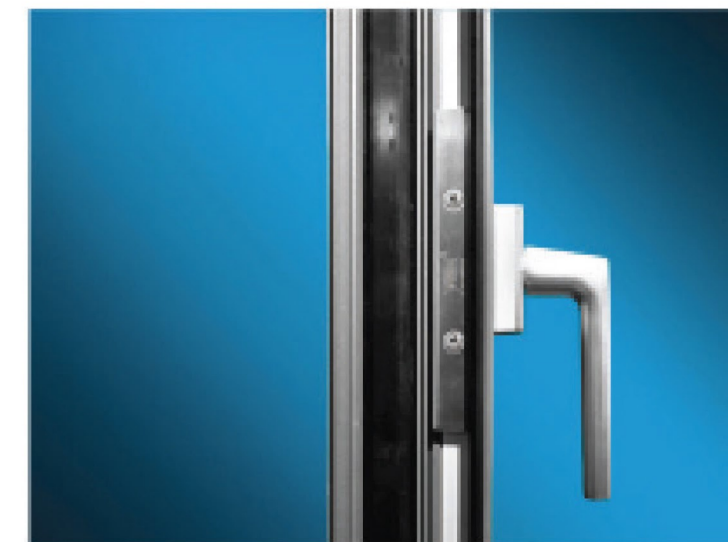
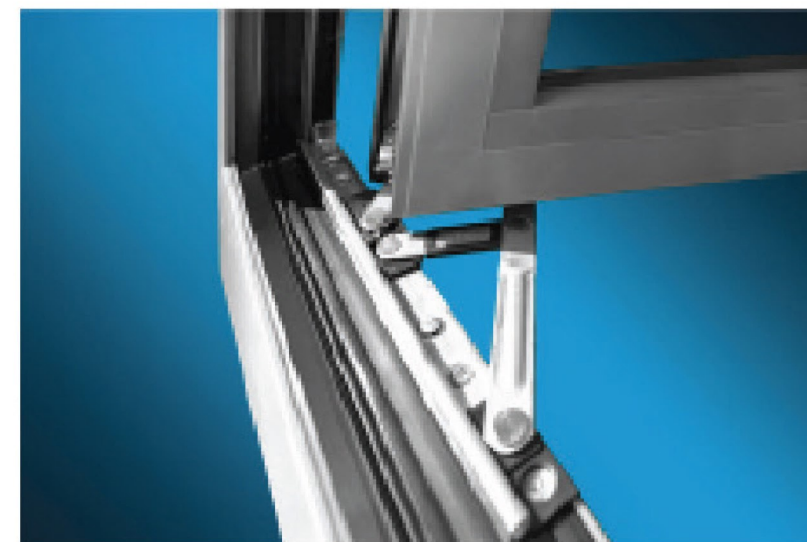
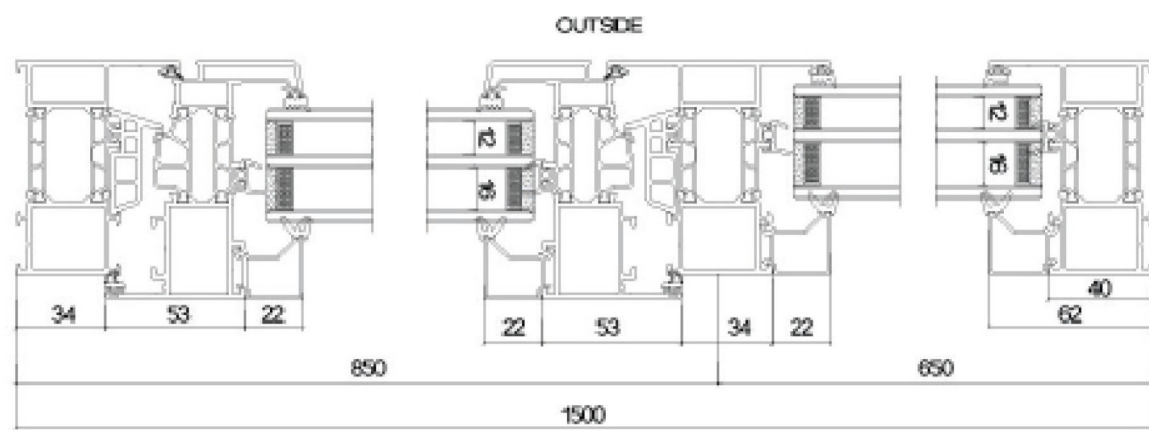
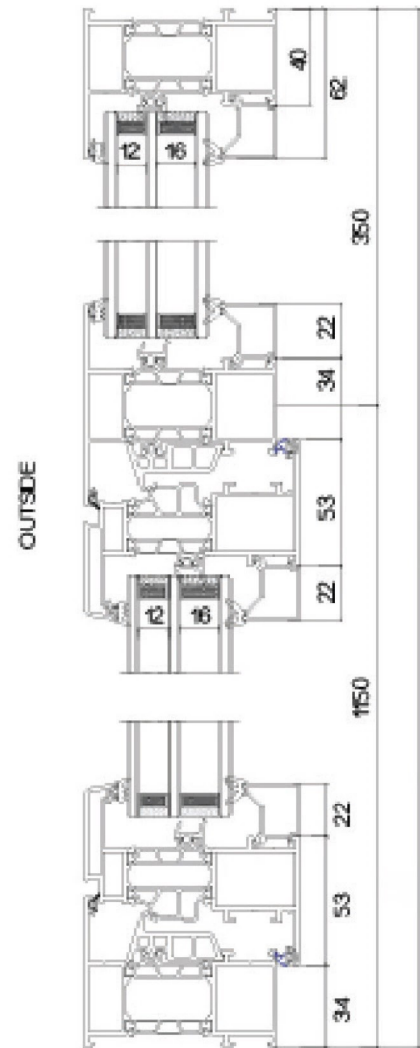

# PRODUCT PERFORMANCE

## DRAINAGE SYSTEM

### Independent Drainage design

The frame and fan independent drainage system design improves the water tightness of the whole window, and the overall design is simple and elegant.

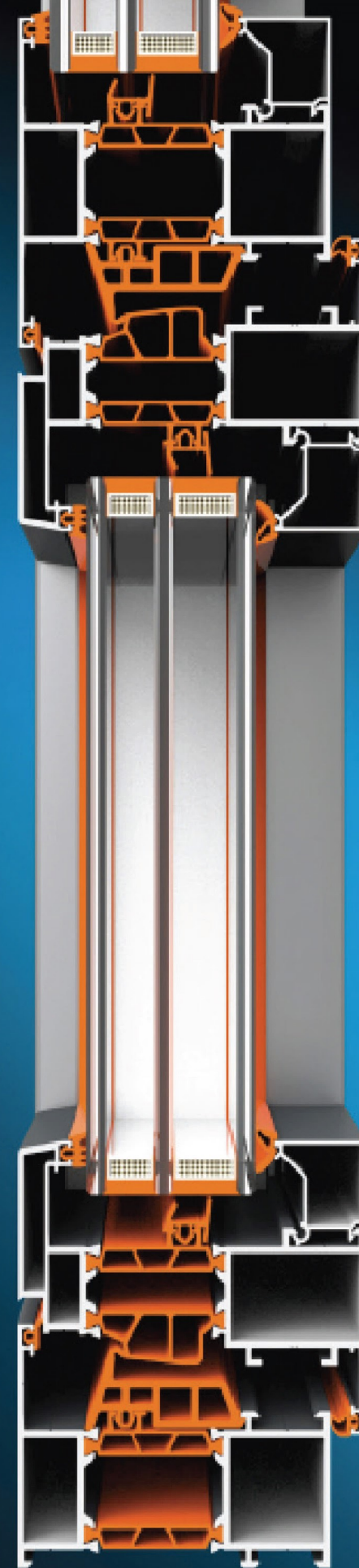

PA66 nylon insulation strip adopts German advanced precision extrusion technology. It has excellent mechanical strength and good weather resistance, resistance to ultraviolet ray aging, acid and alkali corrosion, and has obvious effects of heat preservation, sound insulation and energy saving.

## Profile sealing structure

The German standard process design makes the product air tightness, water tightness, and wind pressure resistance performance effective.

The internal cavities of the form, style, and fan are all designed with a rectangular cavity, and all the glass pressing line is a cavity structure, which is not easy to deform.

## Insulation System

# K80 SERIES THERMAL BREAK ALUMINUM WINDOW

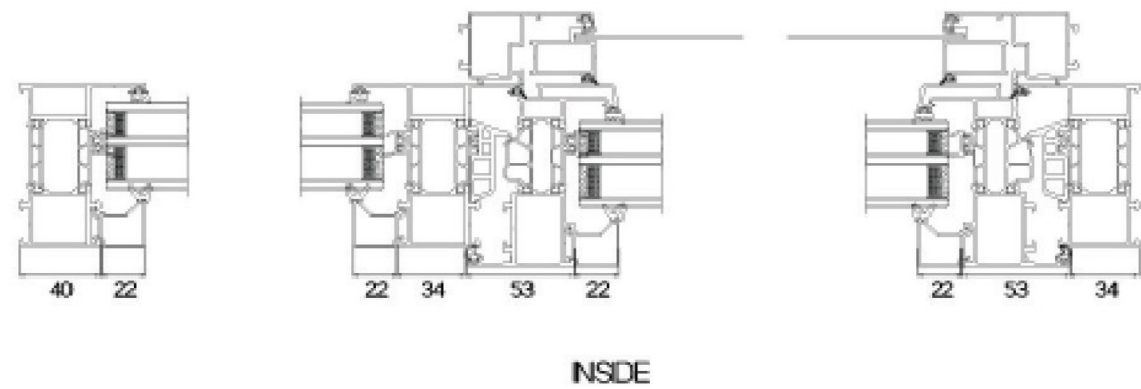
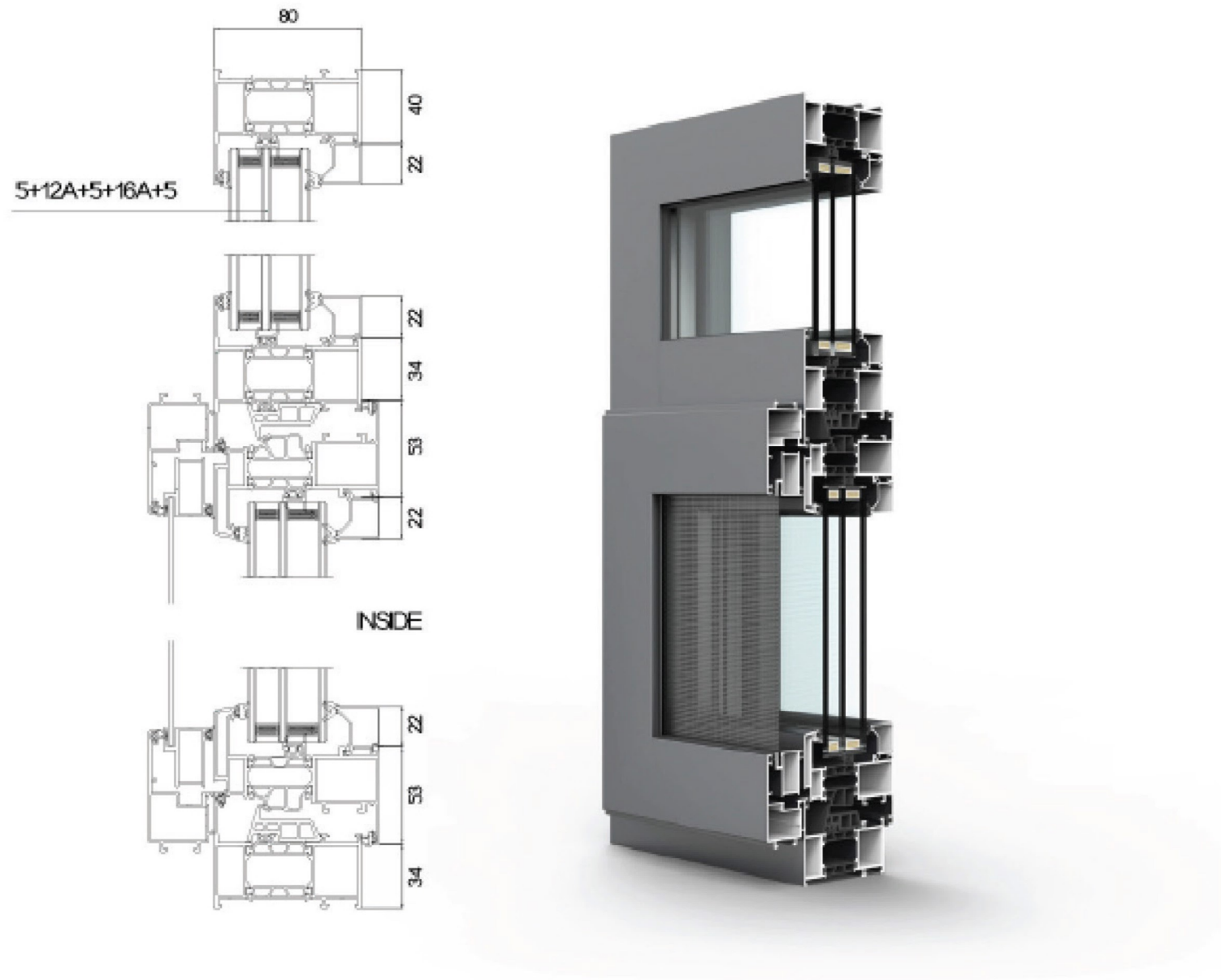

## Product Details

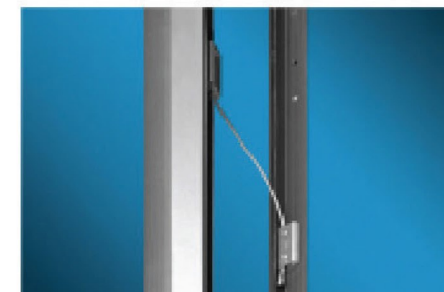
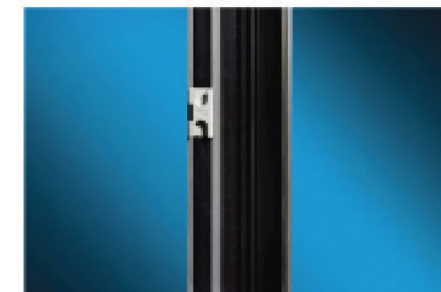
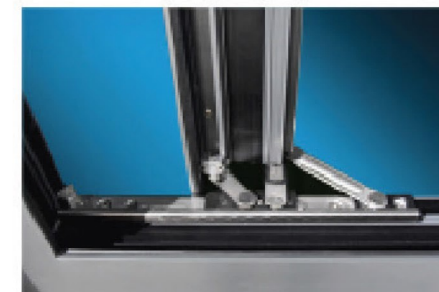



## Simple home life

Create a simple and stylish look, And through the texture of materials and fine craftsmanship to meet the pusuit of high-quality home life. The colors are elegant, clean and lively, and leisure and luxury create a string sense of design.



## Sound Insulation System

Standard three-glass two-cavity hollow tempered glass. Combined with multi-cavity foamed composite isobar. Improve sound insulation performance. Let you enjoy deep sleep at ease.

Super spund insulation up to

# 40dB



# K80 SERIES THERMAL BREAK ALUMINUM WINDOW

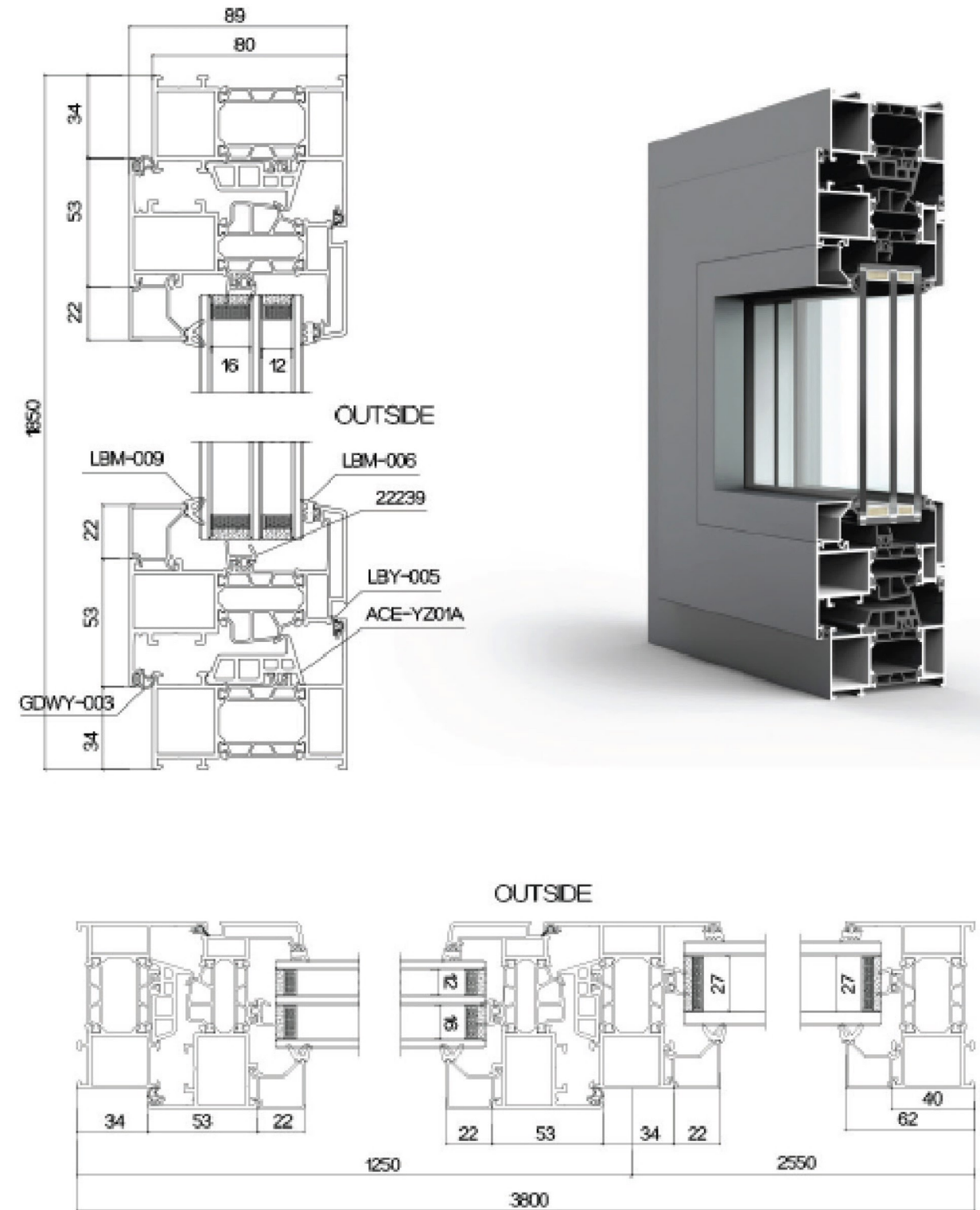
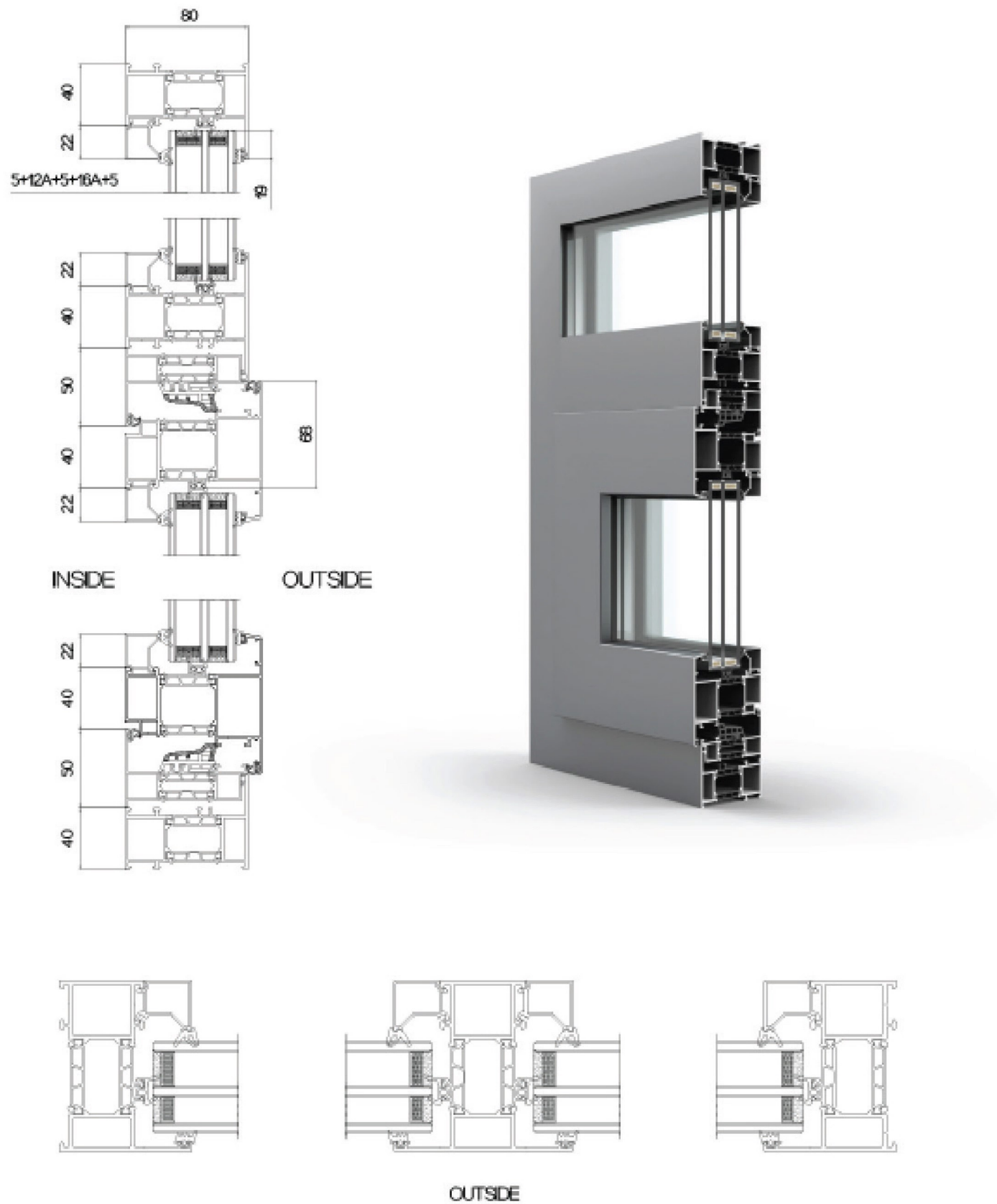

# K80 SERIES THERMAL BREAK ALUMINUM WINDOW

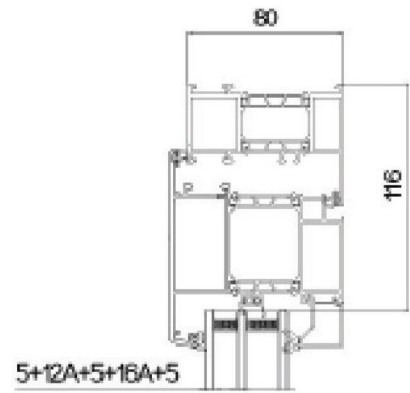

OUTSIDE INSIDE

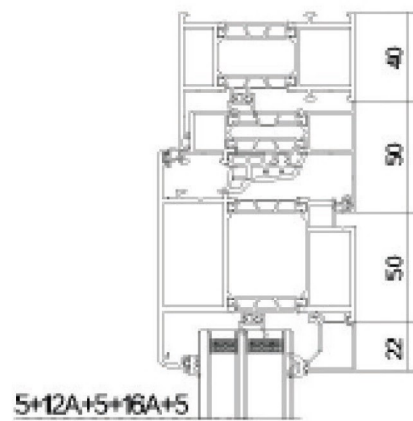
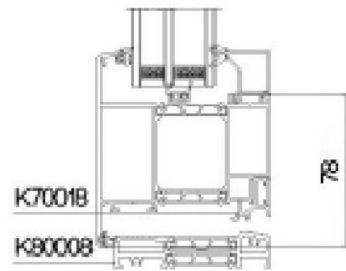

OUTSIDE INSIDE

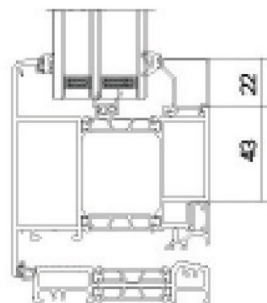

## Casement Doors Series

The door frame and door leaf are all spliced at 45-degree angle, with glue-injected corner code connectors, the connection is firmer and the structure is more stable. The structure of the middle seal is adopted, and the glass is divided into two parts the drainage cavity and the sealed cavity, to prevent the hidden danger of poor sealing at the sealing position.

**35.3**  
Standard heat insulation strip

**1.8mm**  
German craft profile

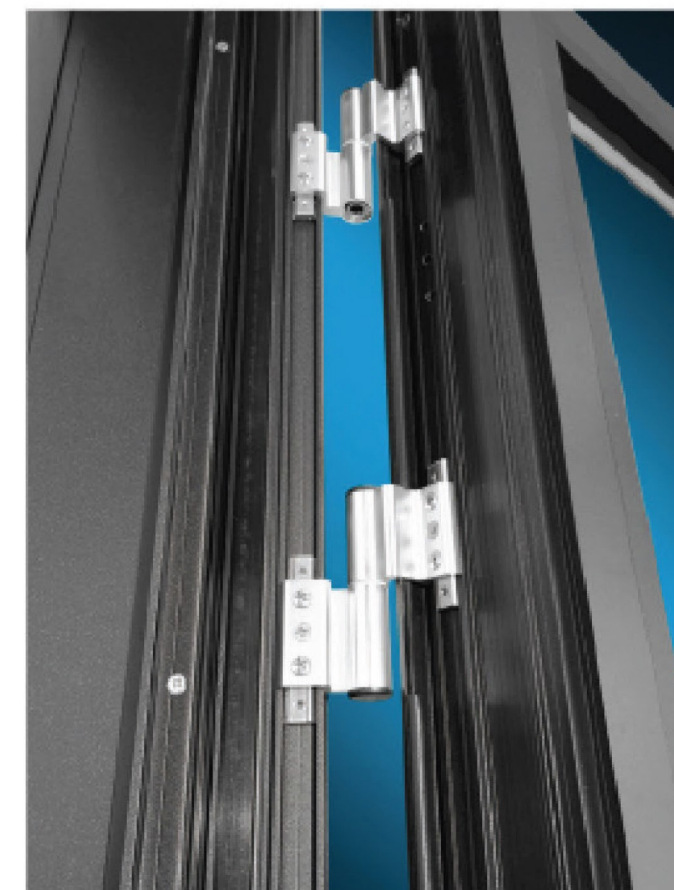

## Product Details

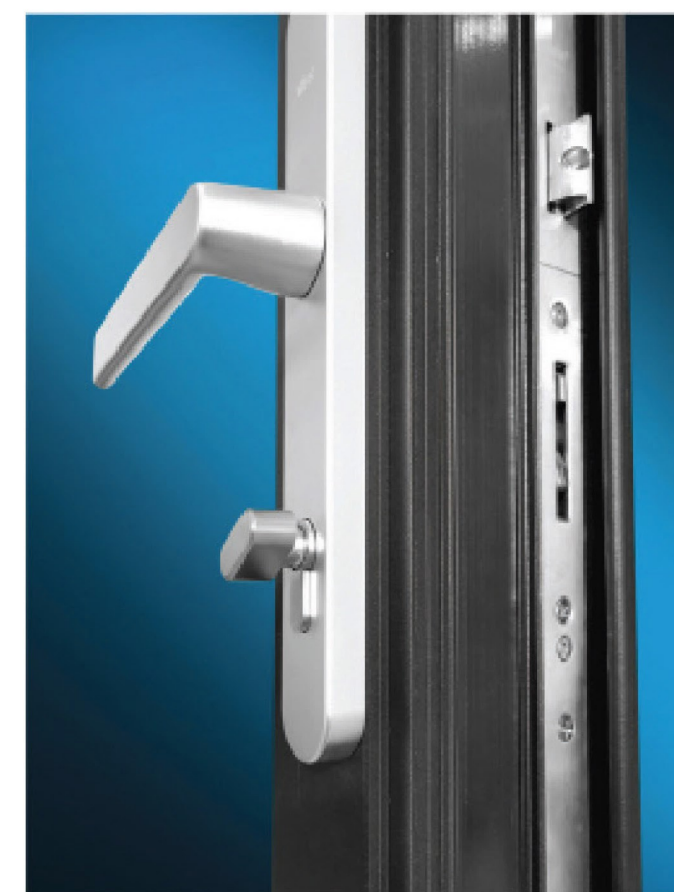



Multipoint Lock



Lock Cylinder



Lock Body



Pulley Double Wheel



Lock bag five piece set



Anti Swing Wheel



Lock Cylinder Cover



Frame Panel

# 96 SERIES

## ALUMINUM SLIDING DOOR

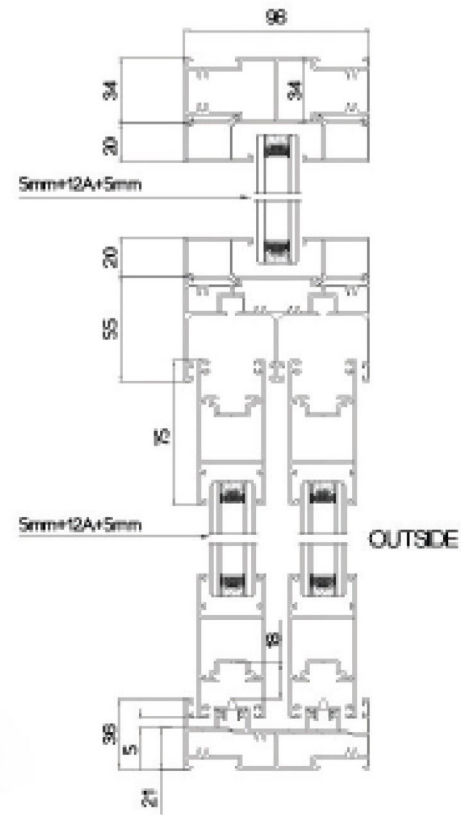

### Product Details

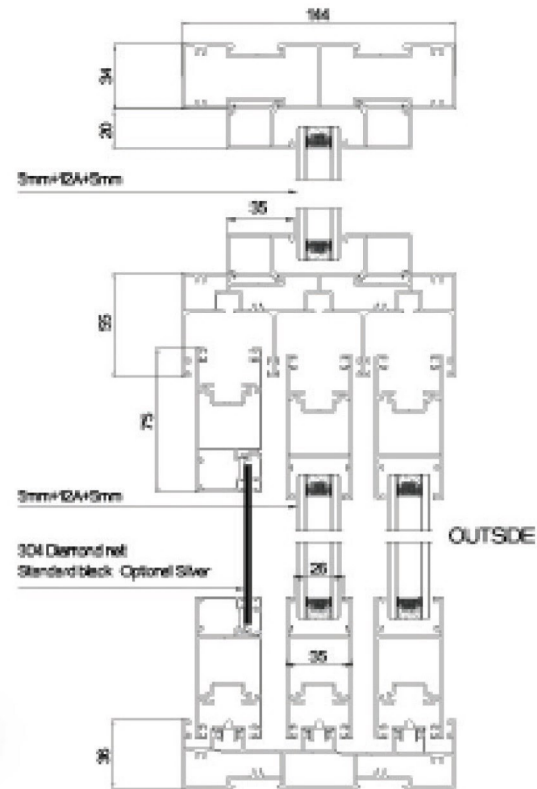
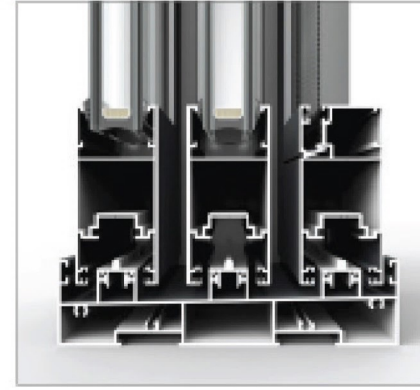
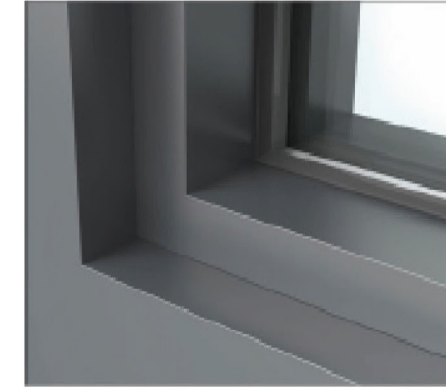

# 96 SERIES

## ALUMINUM SLIDING DOOR

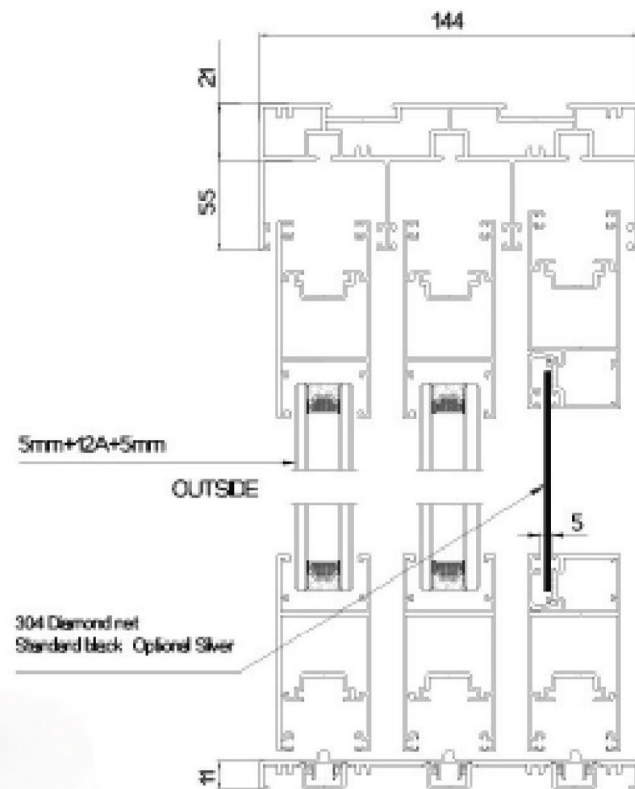
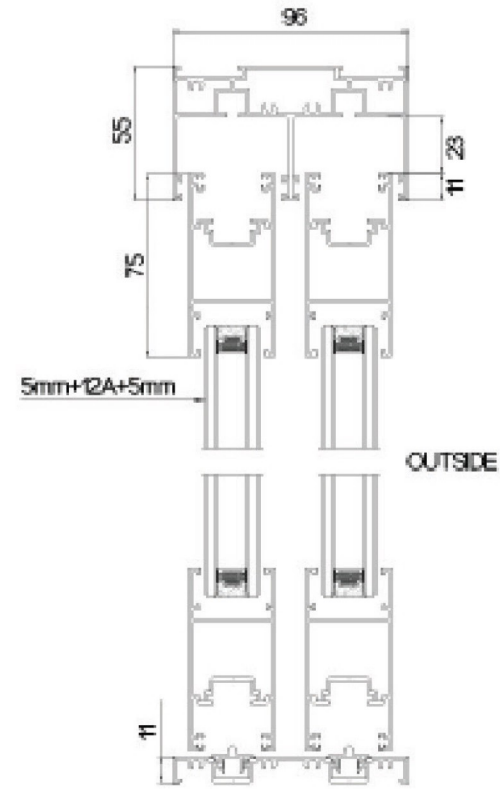

## Space Aesthetics

Space realizes art, and art pursues life simple, bright and elegant, existing and uncompromising of high-level inside, Outside the window is a judge-like picture, and there is a warm and strong fragrance in the room. When you rest, you can recall the time that has passed.





Lock Cylinder



Multipoint Lock



Handle



Lock bag five piece set

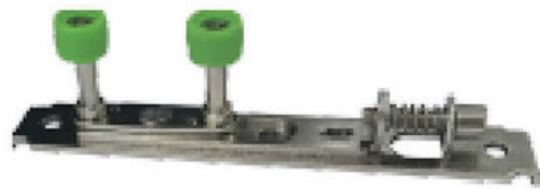

Anti Swing Wheel



Handle Fixing Screw



Lock Body



Play Double Wheel



Lock Cylinder Cover



Frame Panel

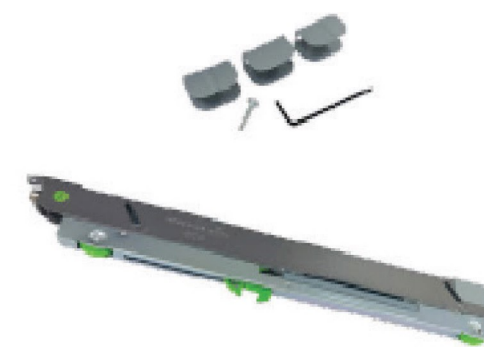

**OPK**  
Buffers and Accessories



# 130 SERIES ALUMINUM SLIDING DOOR

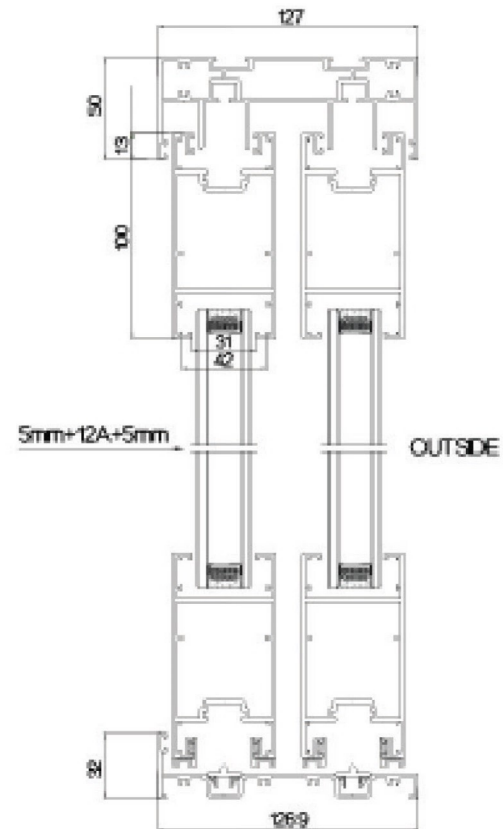

Low rail without retaining edge

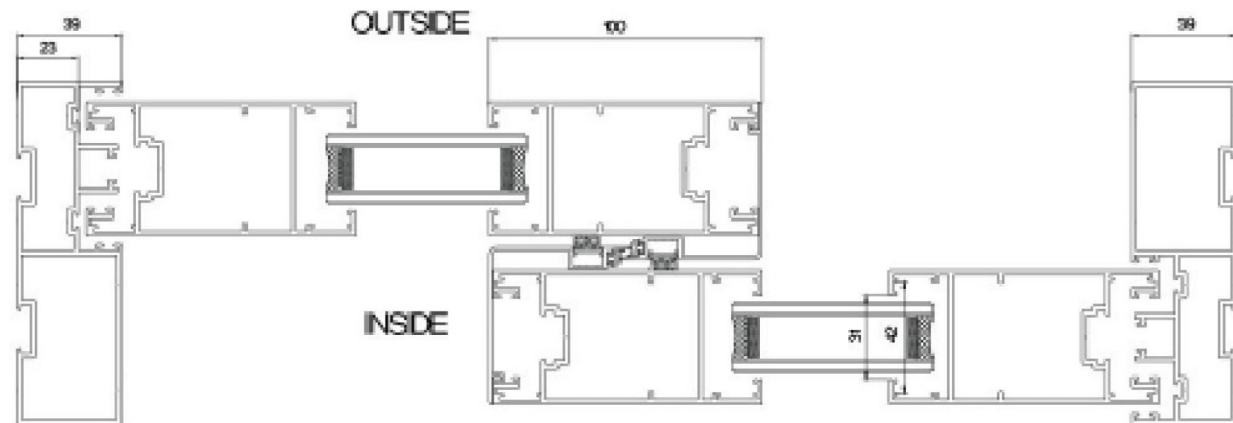

## Product Details

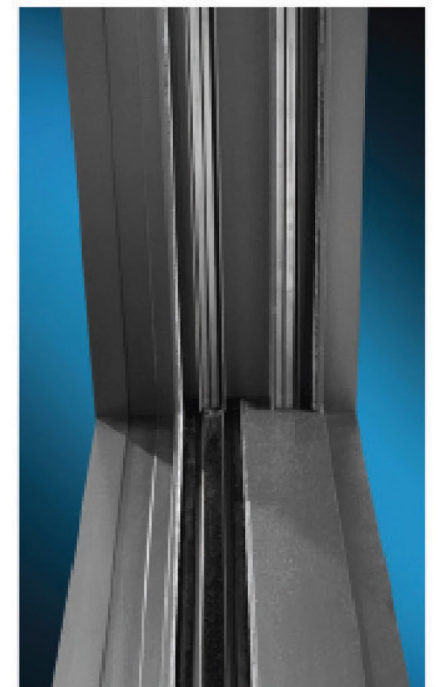
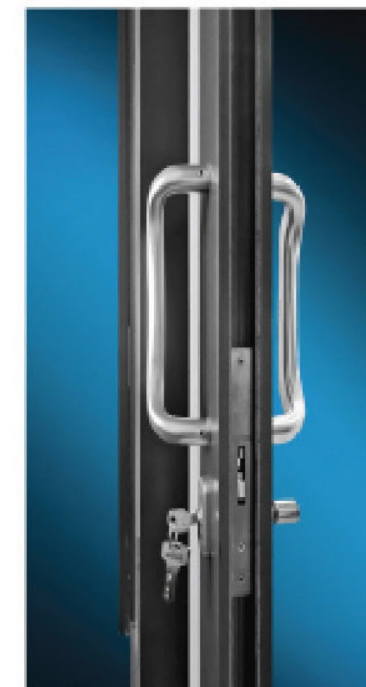

# 130 SERIES

## ALUMINUM SLIDING DOOR

In terms of professional quality, the application of artistic aesthetics was entrusted to an environment manager. From art to life, follow the inner voice, return to simplicity and nature, and beauty meets unexpectedly.

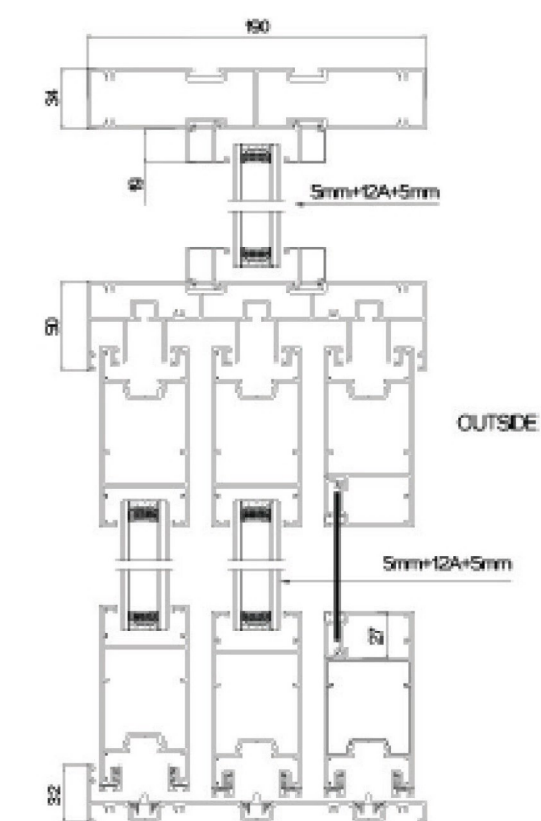
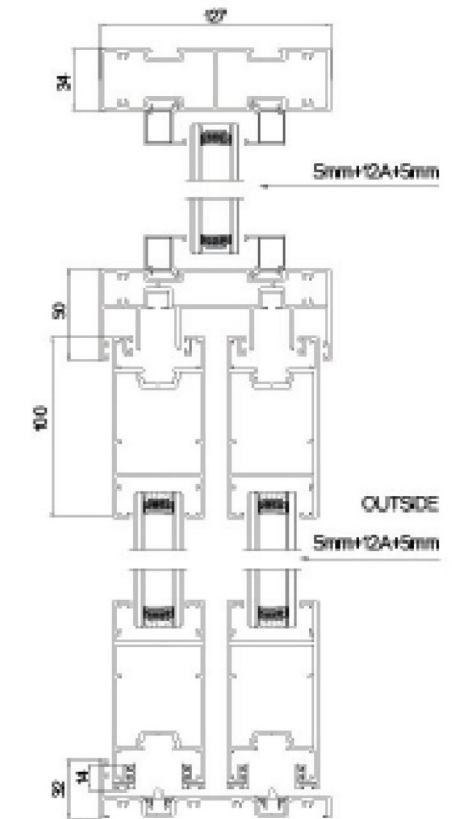

---

# 146 SERIES THERMAL BREAK ALUMINUM LIFTING SLIDING DOOR

---

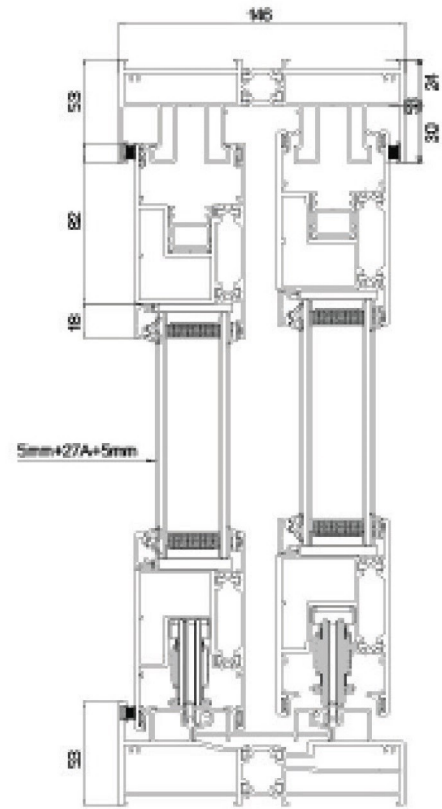



TWO TRACK



Thermal Break Heavy  
**Lifting**



Thick and heavy

More stable



**146** SERIES THERMAL BREAK ALUMINUM LIFTING SLIDING DOOR

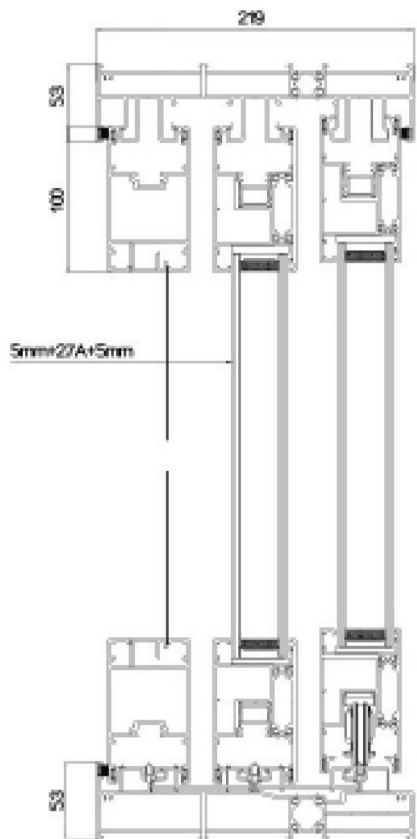

THREE TRACK



Product Details



Thermal Break Heavy  
**Lifting**



# ALUMINUM HEAVY LIFTING SLIDING DOOR

- 1.** The lifting sliding door system adopts the principle of lever, by gently turning the handle to control the lifting of the door leaf.
- 2.** When the handle is rotated downward, the door leaf is opened and fixed driver connected to it.
- 3.** Make the pulley fall on the track of the lower frame, and drive the door leaf up, at this time the door leaf is open (freely sliding and sliding)
- 4.** When the handle rotates upwards, the pulley is separated from the sliding track, and the door leaf is lowered.
- 5.** The door leaf presses the rubber strip on the door frame under the action of gravity, and the door leaf is closed at this time.

# 75 SERIES

## ALUMINUM FOLDING DOOR

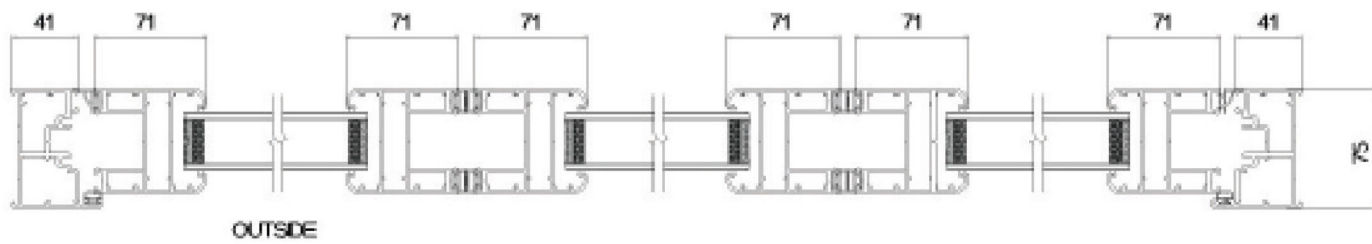
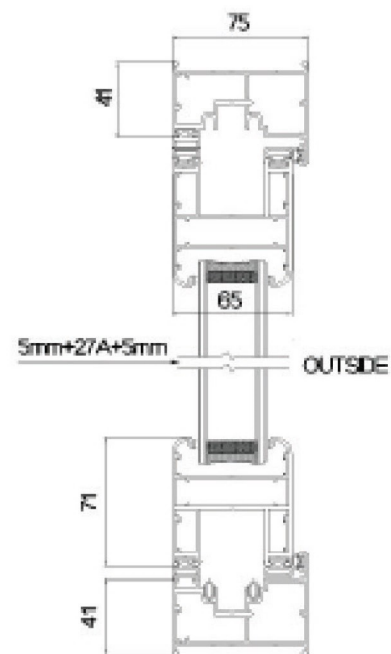

### Product Details

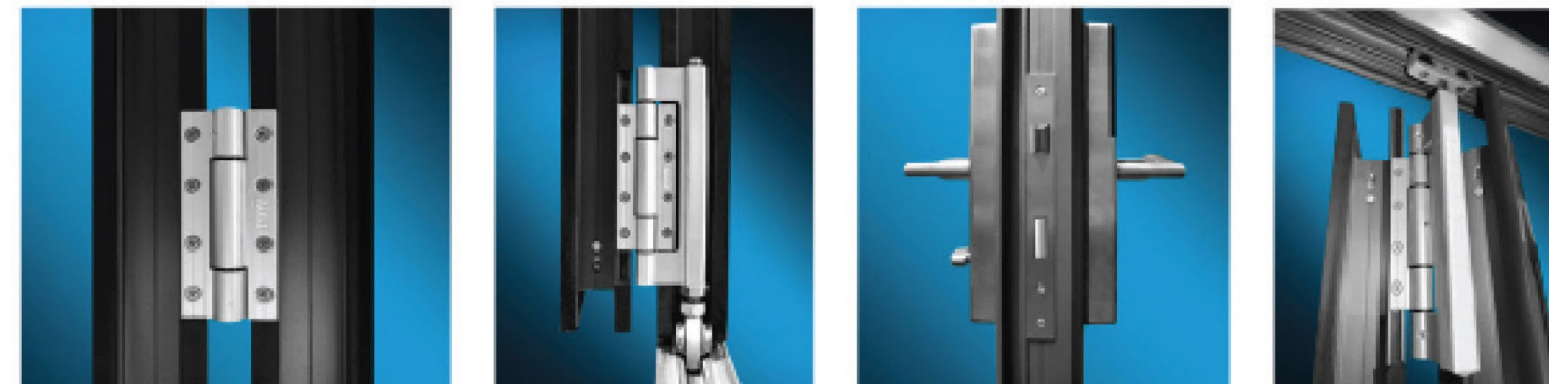



**75** SERIES  
ALUMINUM FOLDING DOOR

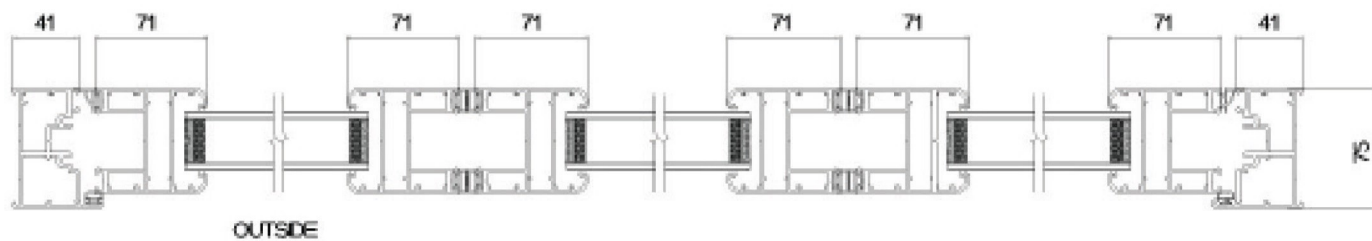
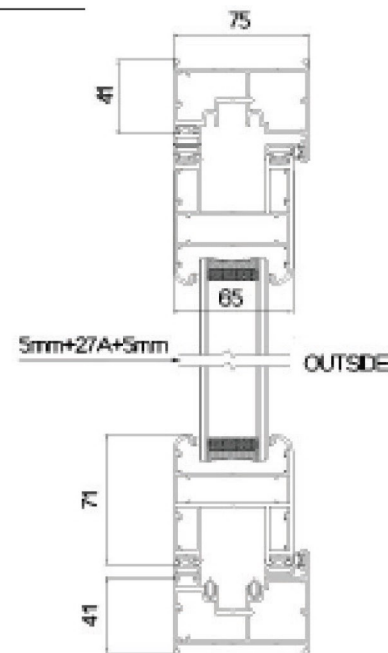

# Folding Door

## Features

After the folding door is unfolded, it can be pushed to the end, occupying very little side space and saving a lot of space.

And the light will not be blocked, which can make the house brighter and have a wider view.



# 68 SERIES THERMAL BREAK ALUMINUM FOLDING DOOR

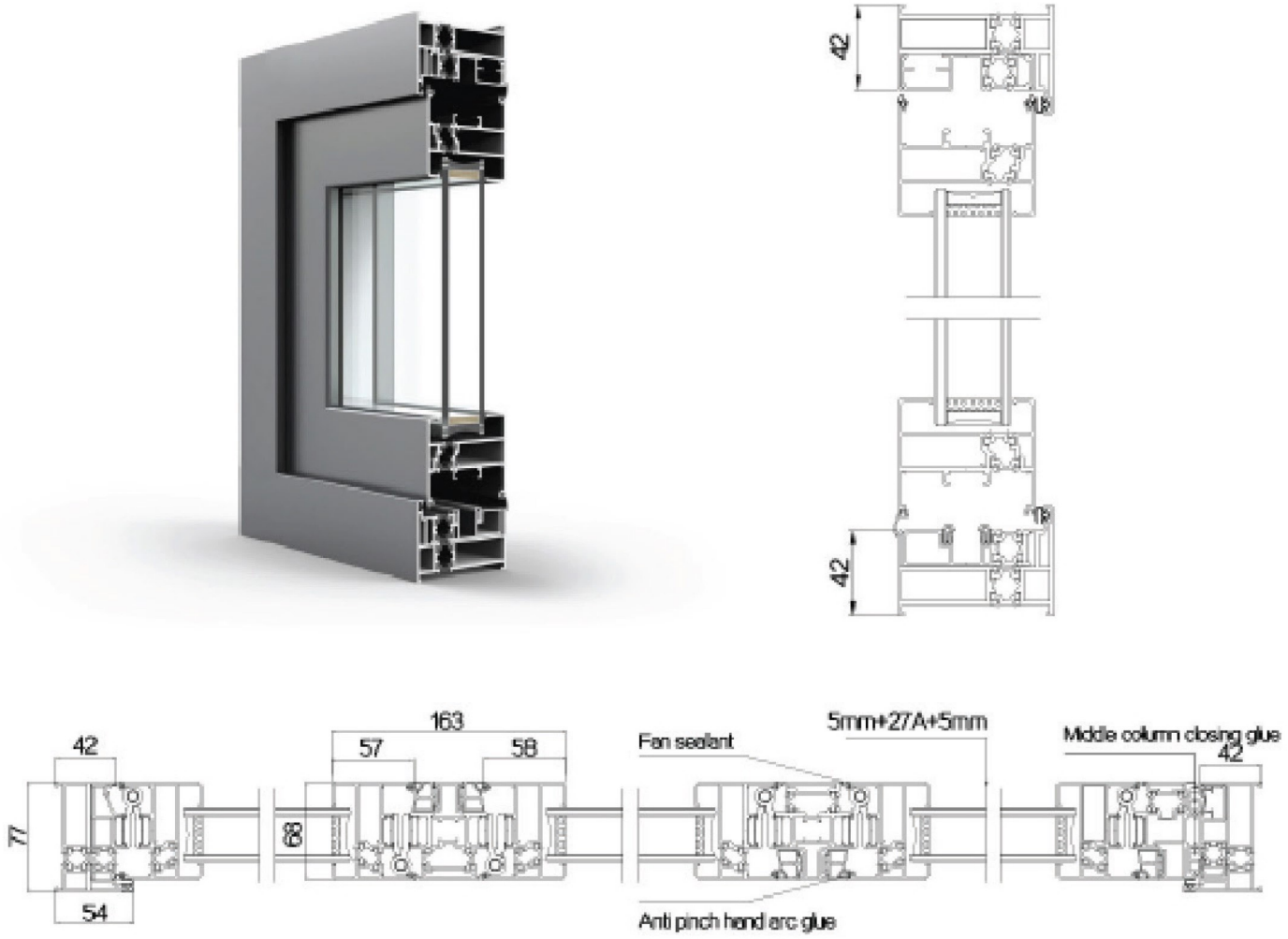

# “ ALUMINIUM SWING HANDLE

PRODUCT  
DETAILS



Fully automatic locking function of the door leaf. Strict protection to reduce hidden dangers.

**Folding door hinge details**



# 120 SERIES THERMAL BREAK ALUMINUM SLIDING WINDOW WITH NET

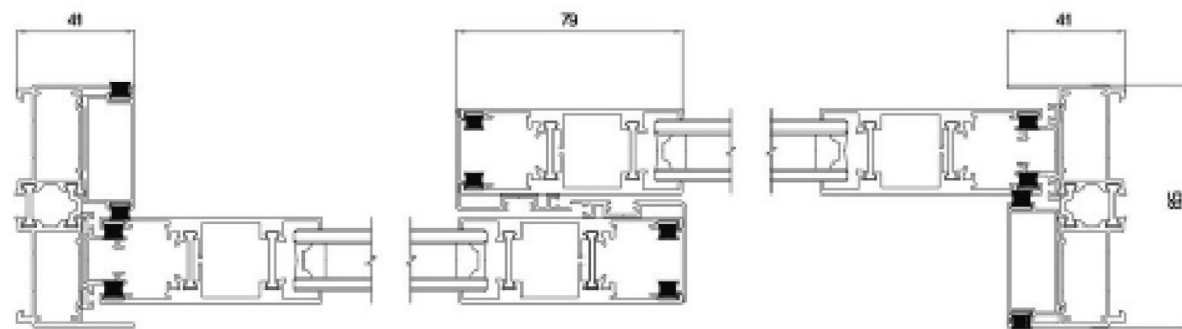
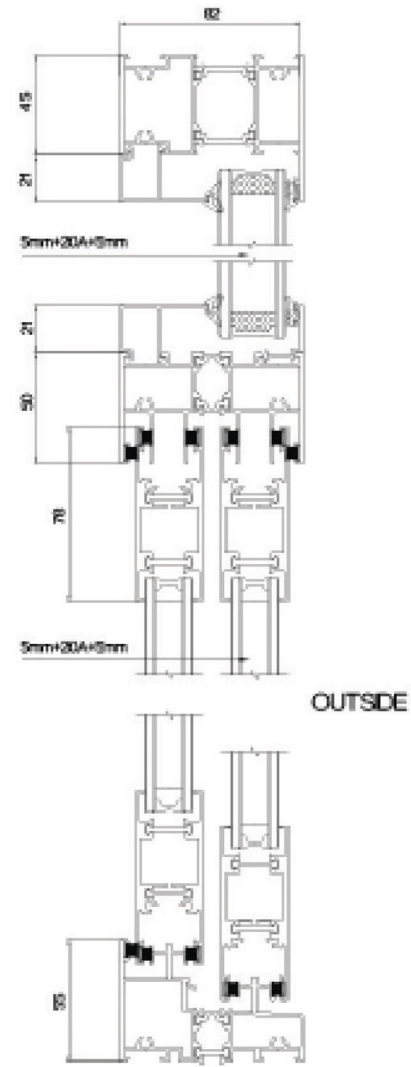

# 120 SERIES THERMAL BREAK ALUMINUM SLIDING WINDOW WITH NET

## Optional lower rail:

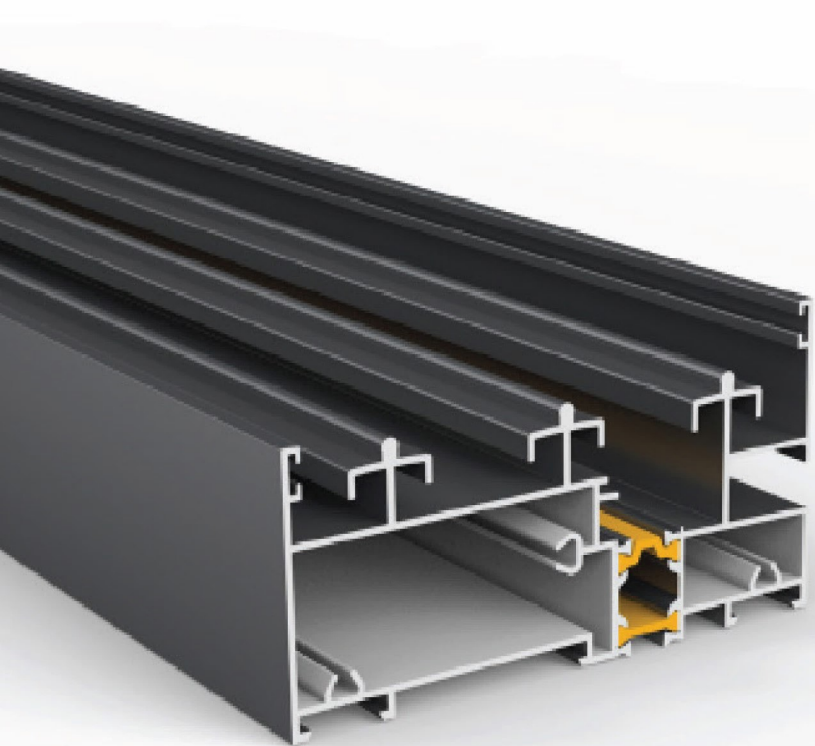
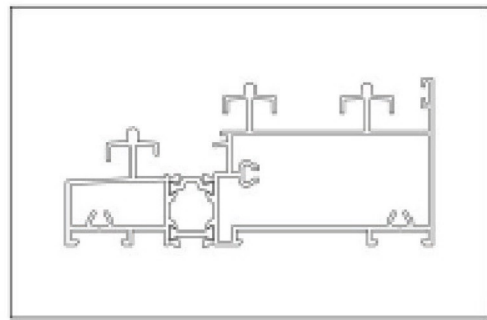
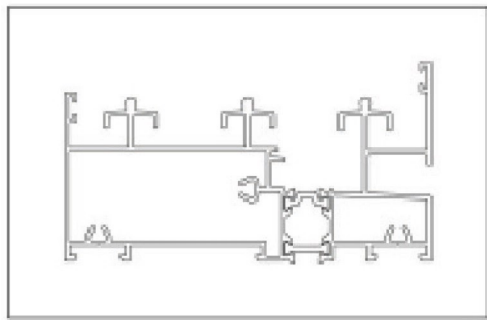

# 120 SERIES ALUMINUM SLIDING WINDOW WITH NET

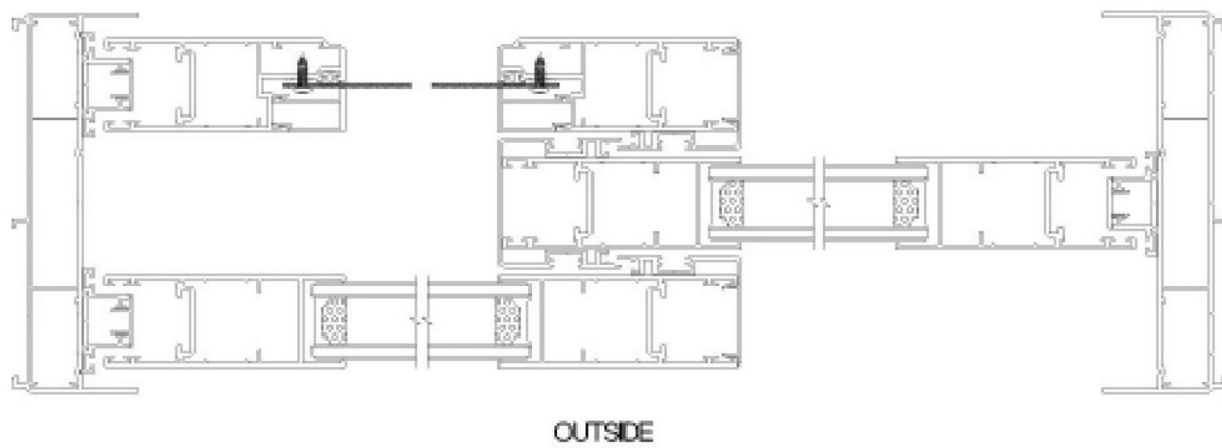
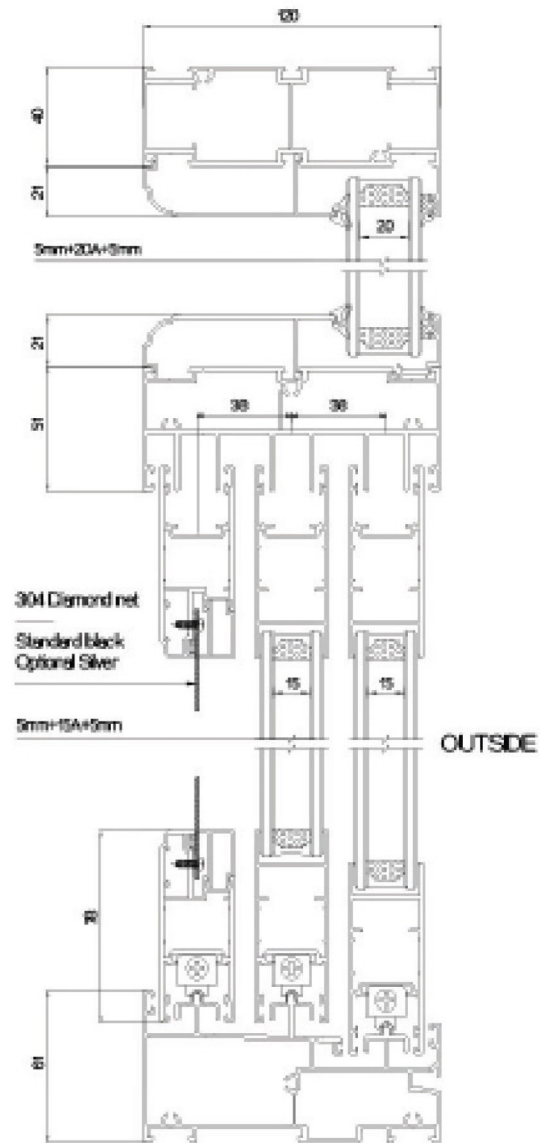

## Product Selling Point

# Arcline Pressing

It can be used as an arc crimping line or square crimping line. The crimping line is flush with the cutter frame. There is no seepage or accumulation of water in rain and snow. Both use and beauty, integrated into the modern aesthetic design, no-collision. Take care of you from subtleties.





Upper and lower hinge



Transmission Box



Lock block + side drive rod



Lock Body

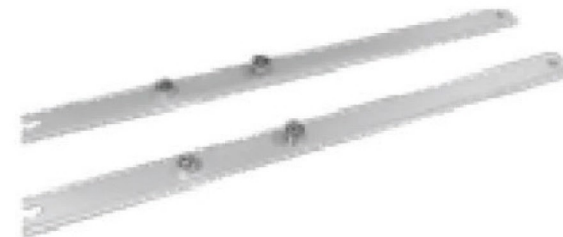

Aluminum Drive Rod



Friction Stay



Aluminum Connector



Frame Panel

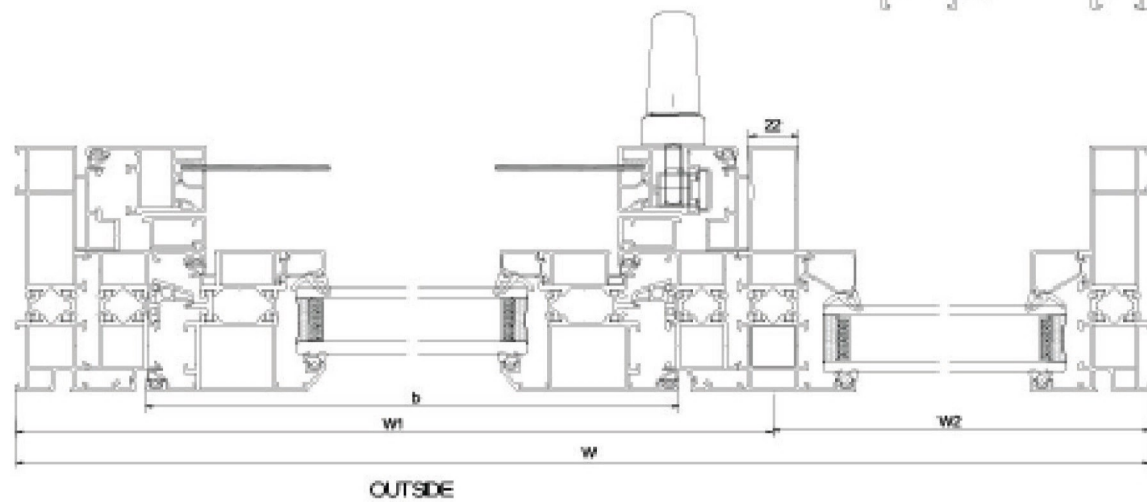
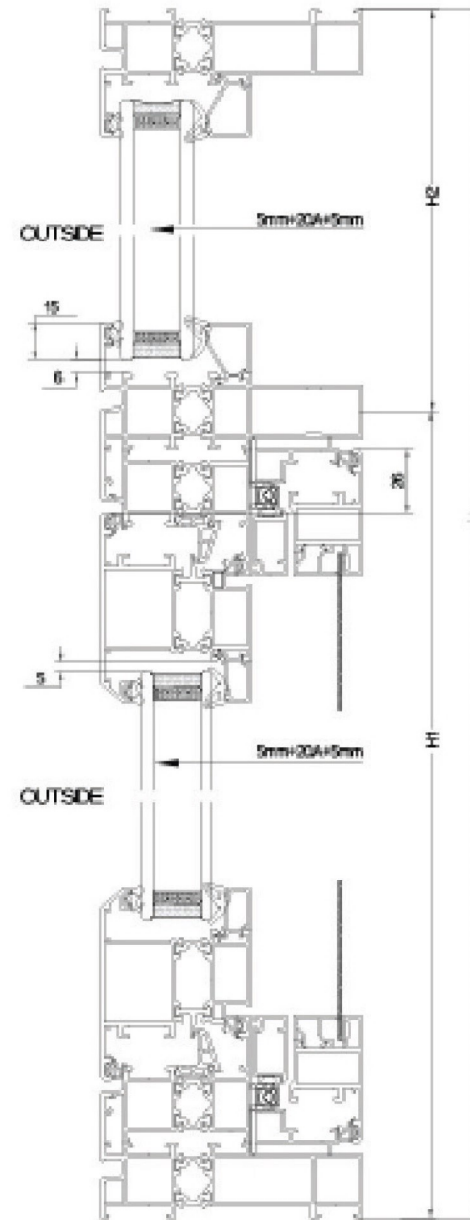

## Simplicity Life

Find a home to store your busy heart, without the noise and irritability of the world. Without the worldly complexity and helplessness, find your heart and make life easier and simpler.





## KEEP IMPROVING MANUFACTURING PROCESS

Continuously innovative R&D technology, excellent manufacturing process, the ingenious details touched people's yearning for a perfect life.



## Product Details

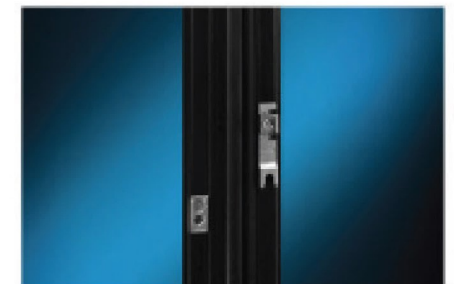
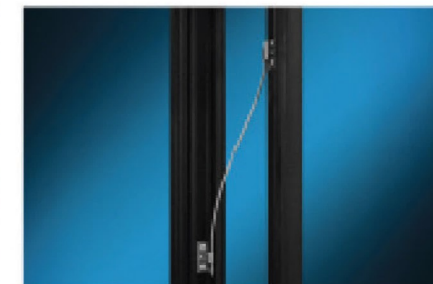
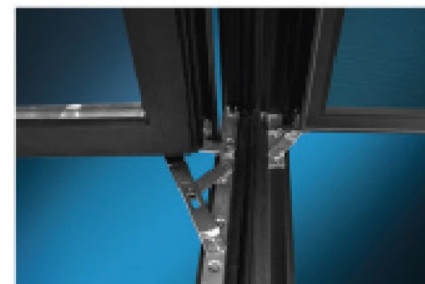



Wind Bracing



Lock Cylinder



Drive rod - lock seat - lock point - connector



Transmission Box



Lock Cylinder Cover



Hinge



Handle



Handle

# 50 SERIES

## ALUMINUM CASEMENT DOOR

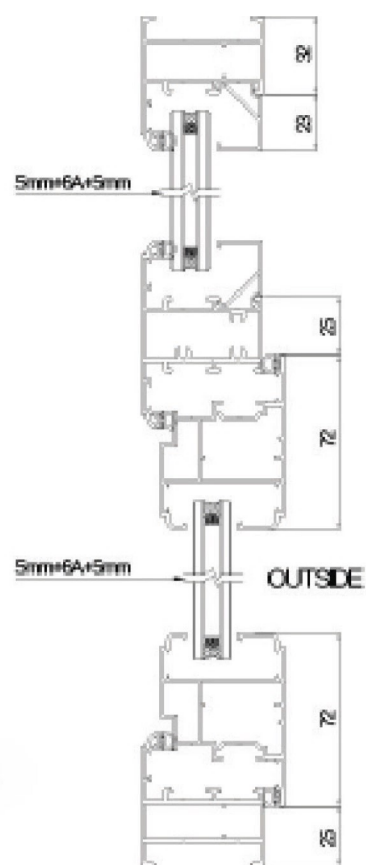
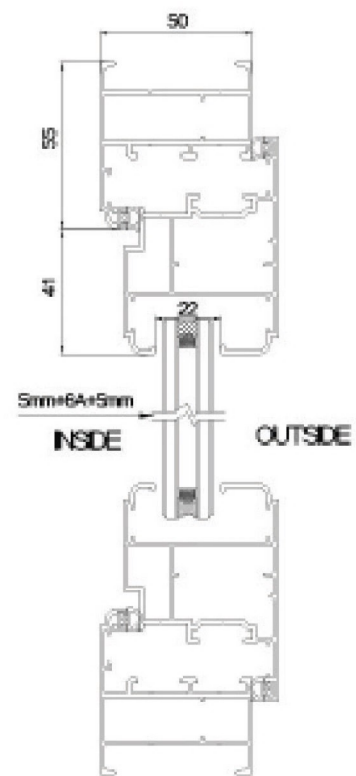
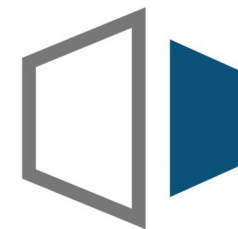

## HIGH PERFORMANCE

### SYSTEM DOOR & WINDOW

Fully consider every detail to fully support the positioning of high-performance door and windows.

# 50 SERIES

ALUMINUM CASEMENT DOOR

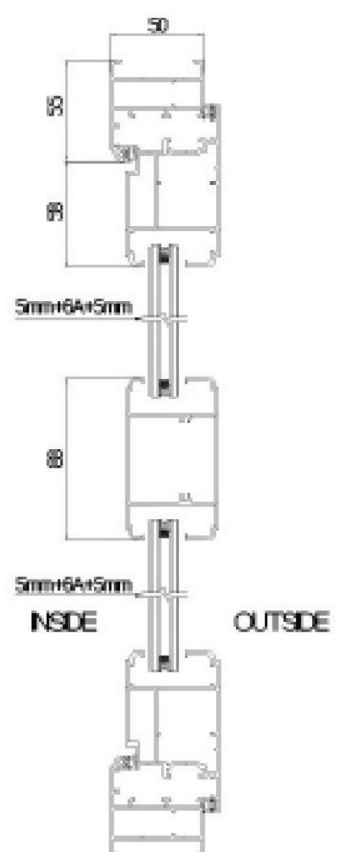
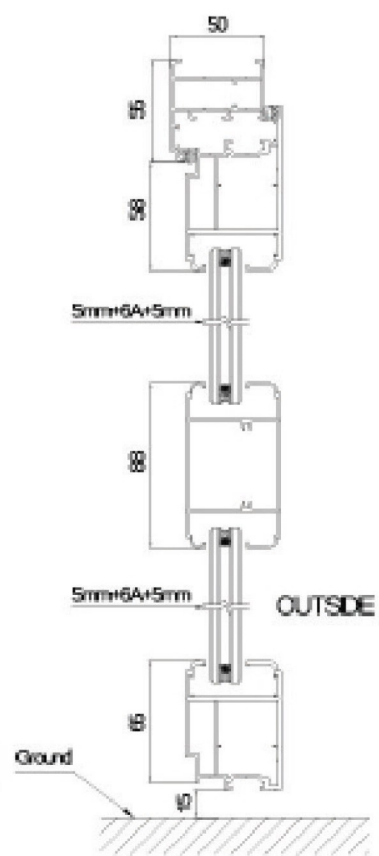

# 16 SERIES

## NARROW FRAME ALUMINUM CASEMENT DOOR



### Processing dimensions of doors and windows:

Width: 865mm Height: 2385mm

**Glass:** It adopts glass glue free process and 8mm tempered European gray double-sided jade sand glass.

**Package:** Outside semi jacketed mode.

**Remarks:** Lifting leg 10mm; Standard configuration: magnetic suction square handle lock mode.

# 16 SERIES

## NARROW FRAME ALUMINUM CASEMENT DOOR

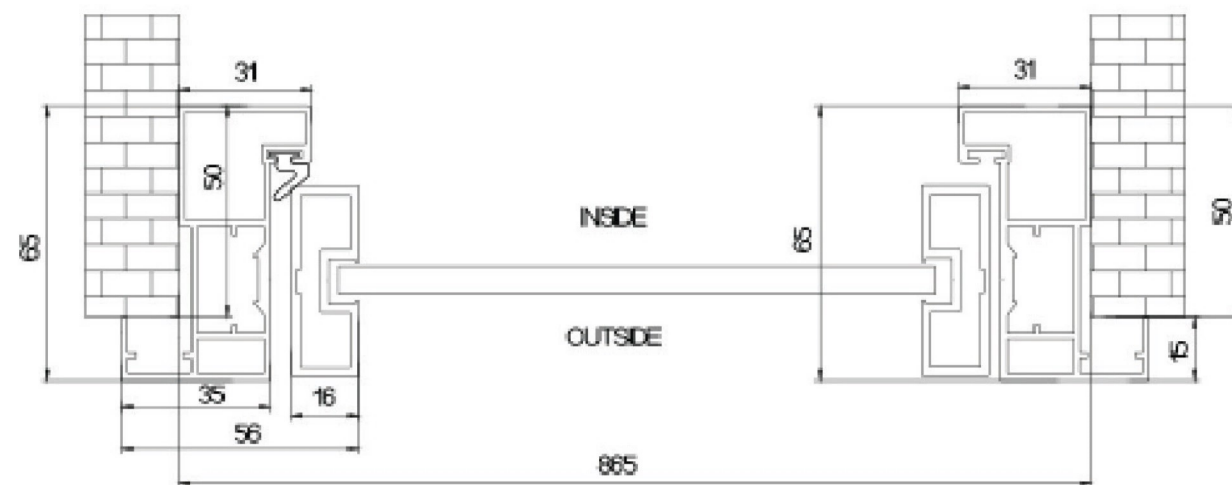
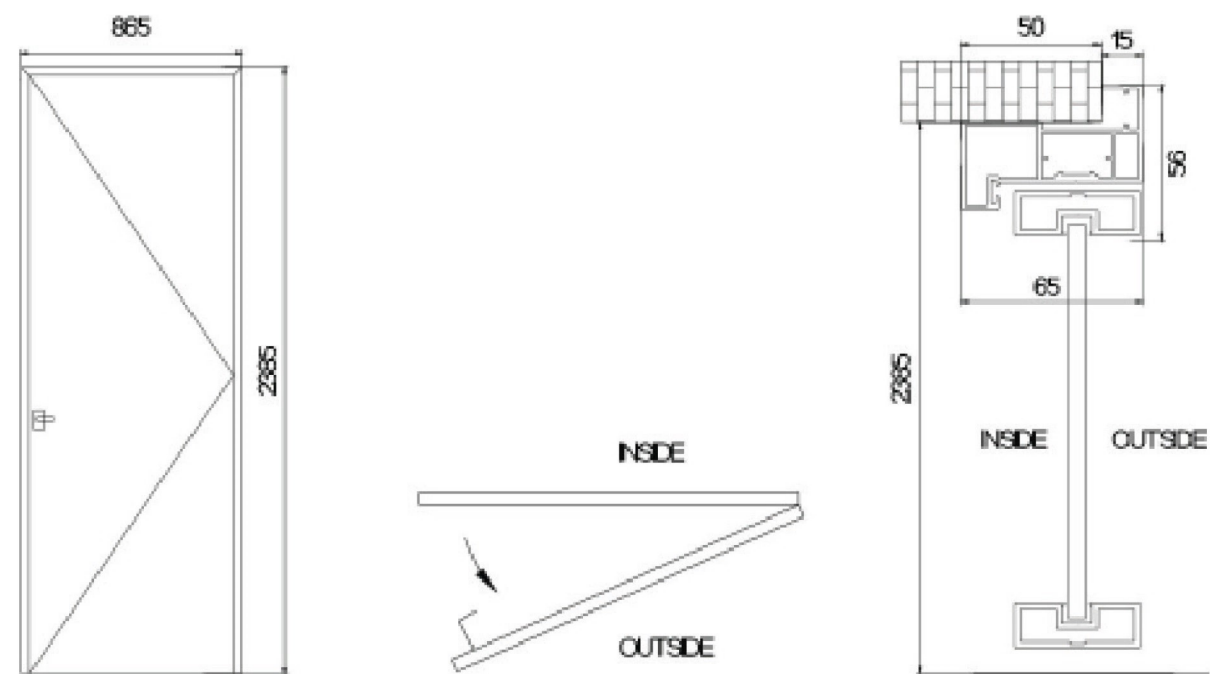



# 16 SERIES

NARROW FRAME ALUMINUM CASEMENT DOOR

## DOUBLE JACKET

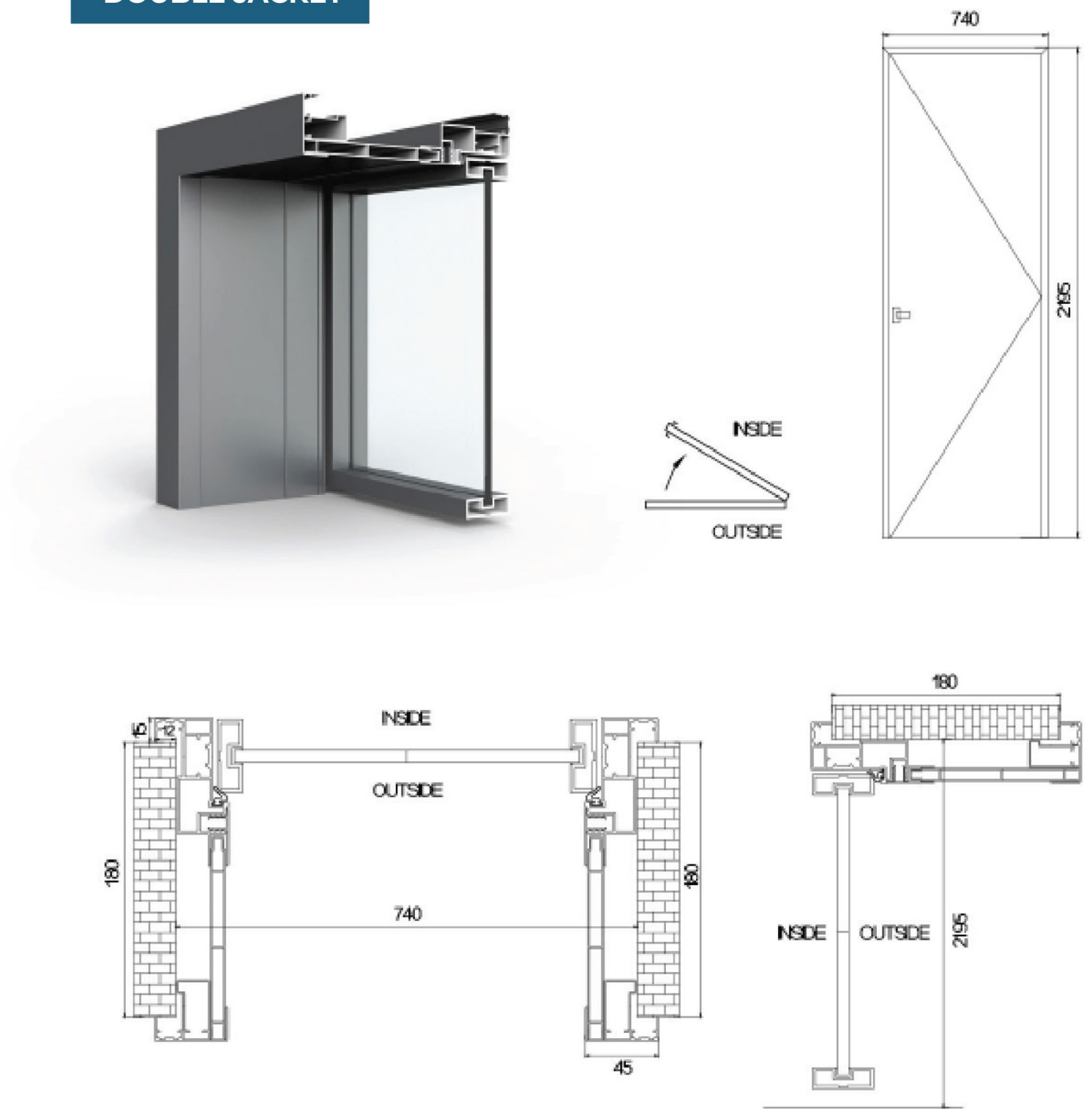

# 18 SERIES

## NARROW FRAME ALUMINUM CASEMENT DOOR



### Processing dimensions of doors and windows:

Width: 817mm Height: 1925mm

**Glass:** 5mm frosted glass + 15A + 5mm Changhong glass  
 The glass frosting surface is on the indoor surface; Changhong glass is outside the room. The concave convex surface of Changhong glass is made in the hollow layer.

**Package:** Double dad mode, wall thickness 190mm.

**Remarks:** Lifting leg 10mm; The standard configuration lock adopts square lock (magnetic suction mode)

# 18 SERIES

## NARROW FRAME ALUMINUM CASEMENT DOOR

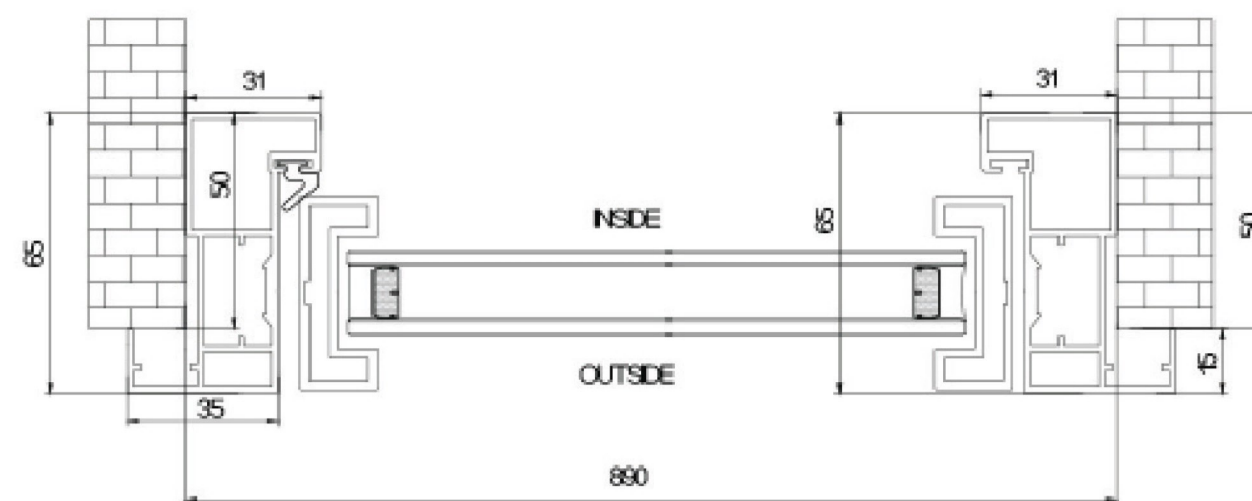
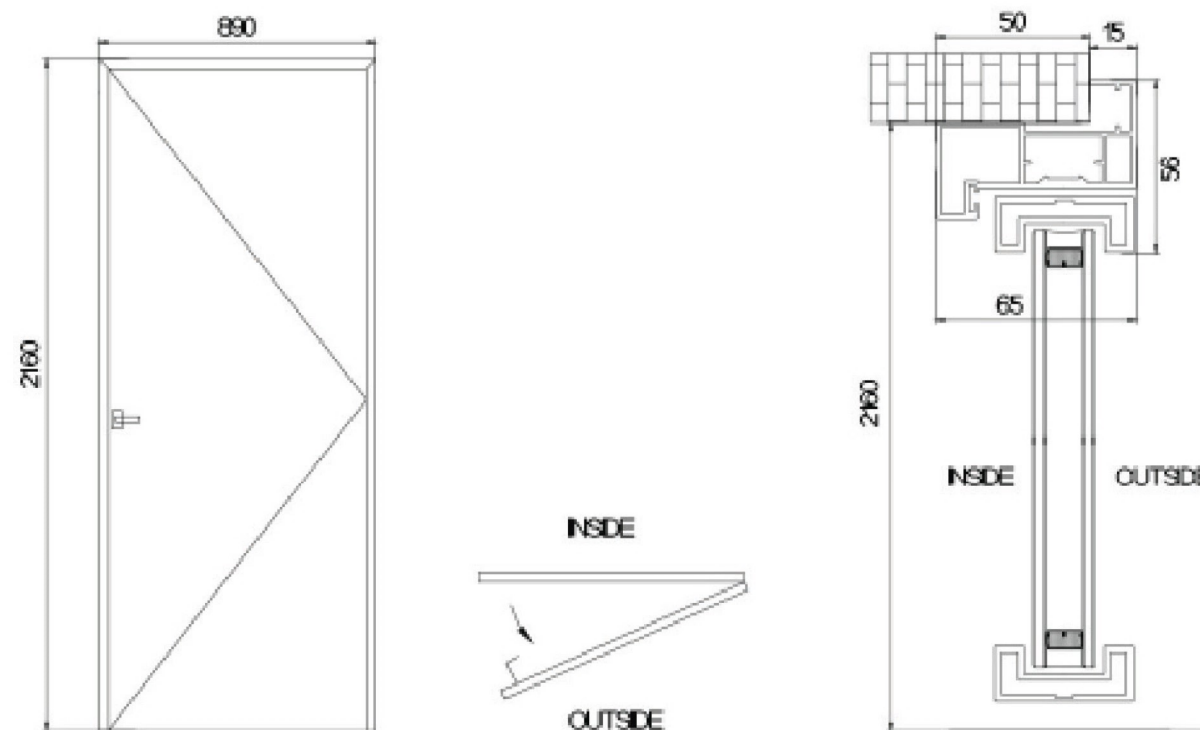



# 18 SERIES

## NARROW FRAME ALUMINUM CASEMENT DOOR

### DOUBLE JACKET

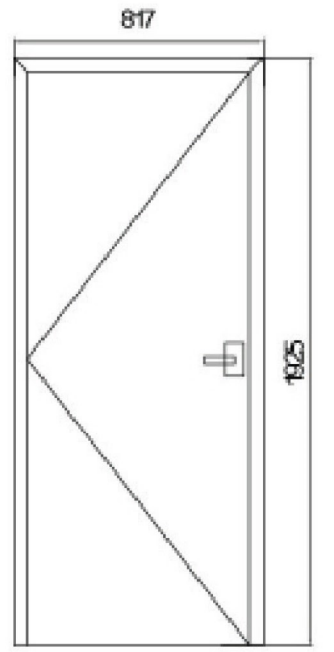
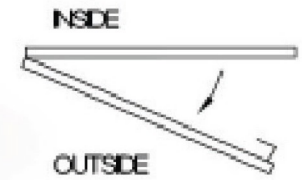

Remarks: lifting leg 10mm

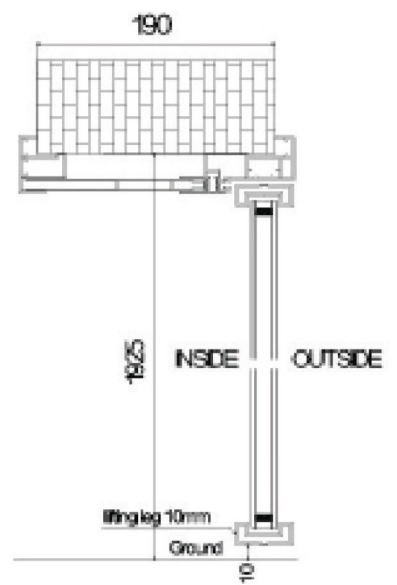
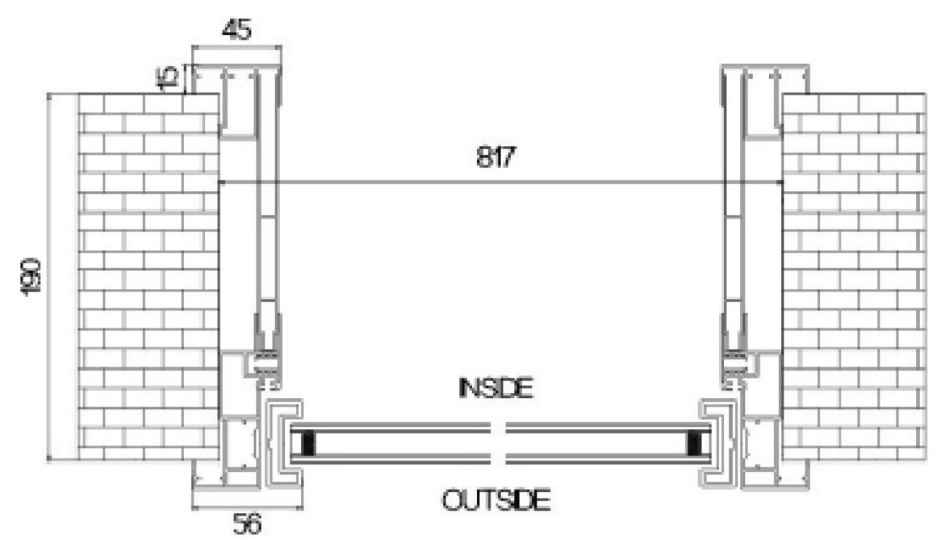



## Product characteristics of sunshine house

1. If your housing areas is large, especially for villa buildings, your sunshine room is mainly used for fitness, flower raising, etc. you should choose an overall mobile sunshine room with a movable roof. This kind of sunshine room will not have the problems of poor daylight if insulation board sunshine romm and high indoor temperature of fixed daylighting roof sunshine room in summer.

2. If you are building a leisure house with high privacy requirements and low economic level in order to expand your living space because of the small housing area, you can choose insulation board roof, plastic steel doors and windows and insulation wall as peripheral maintenance products. Although these products are not sunshine houses in the strict sense, they are low in price economical and practical. The disadvantage is poor daylight and general ventilation. If the skylight is added, it will be greatly improved.

3. If it is a sunshine room that needs traditional building functions (such as characteristic living room, study, activity room, etc.), it is advisable to choose a tempered hallow glass roof, equipped with an appropriate amount of special hollow glass skylight, and use bridge broken aluminum hollow glass window or aluminum wood composite hollow glass window for peripheral maintenance. Special sunshades, sunshades, invisible screens and other products are also required.

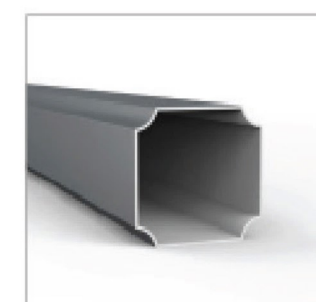
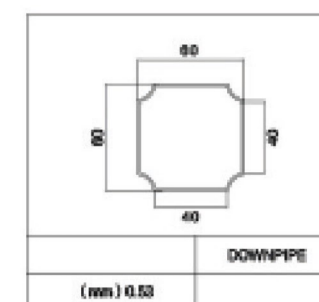
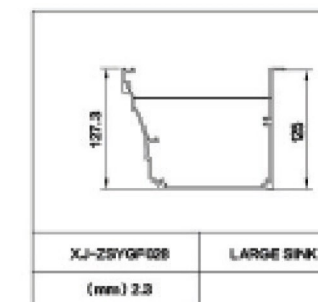
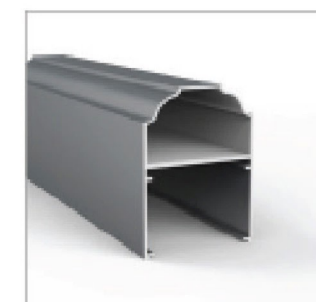
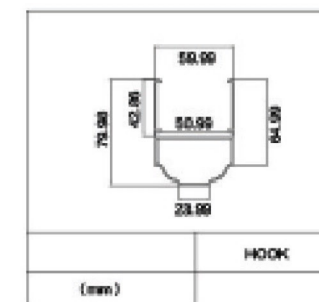
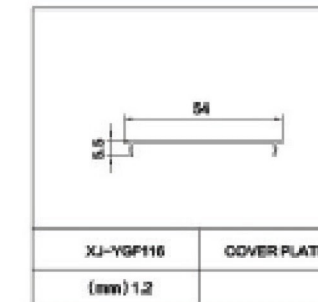
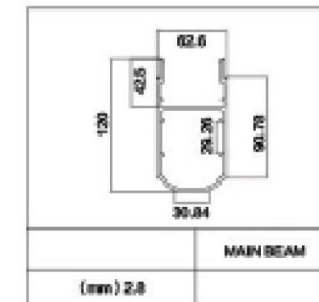
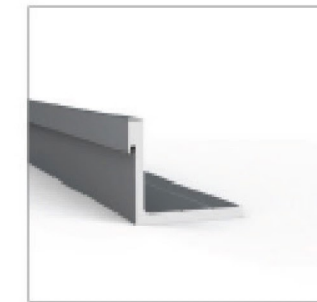
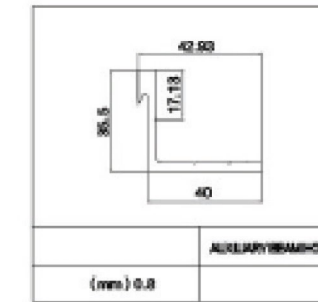
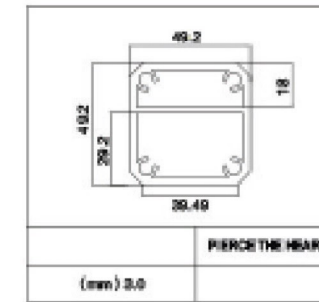
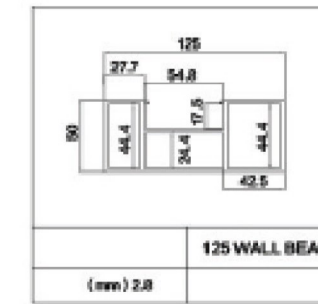
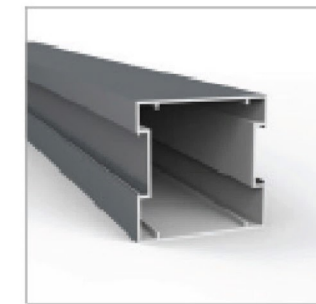
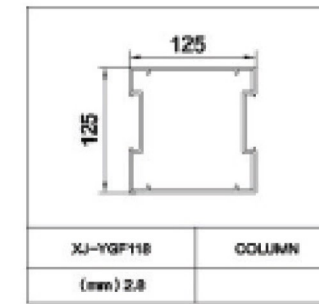
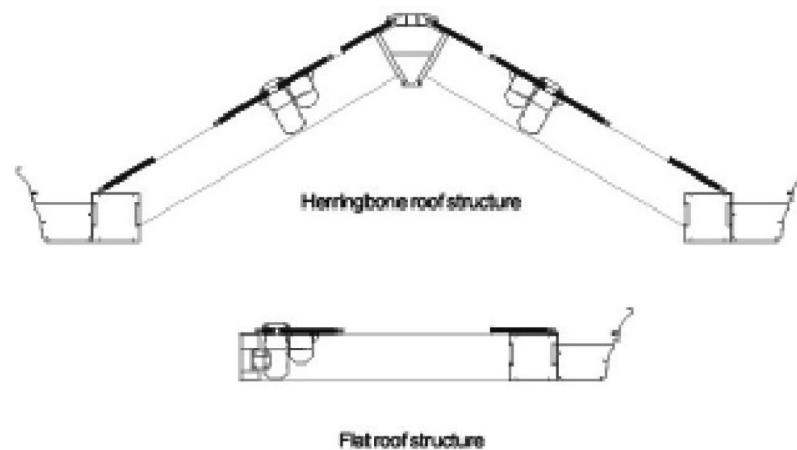

Whether in the garden or on the terrace.  
Wanja doors and windows tailor-made the exclusive  
sunshine room shape for you.

## Customize Your space



# 120 SERIES ALUMINUM SUNROOM WITH LIGHT

## Product characteristics of sunshine house

The New Chinese Classical style is based on the background of Chinese traditional classical culture, creating a Chinese-style living space. Mahogany, blue and white porcelain, purple sand teapots and some mahogany crafts all reflect the strong oriental beauty. The New Chinese style pays great attention to the sense of hierarchy of space. Through this new separation method, using Chinese-style screens or window frames, it shows the hierarchical beauty of Chinese families.

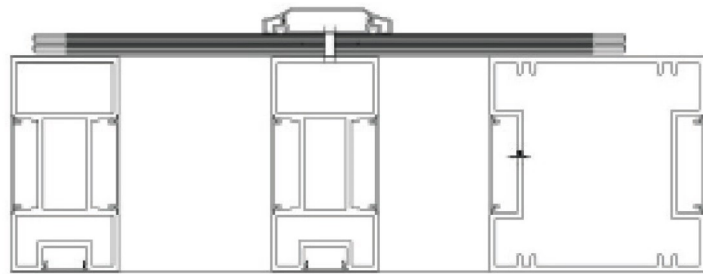

CONTAINING  
**LAMPS**

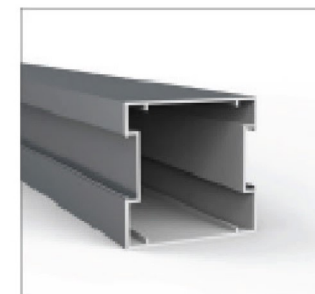
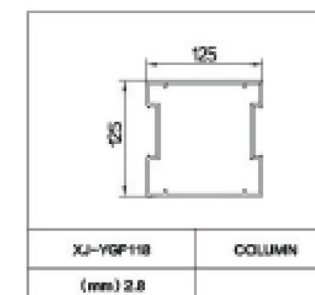
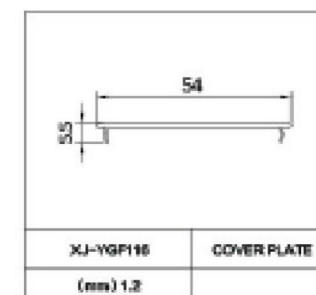
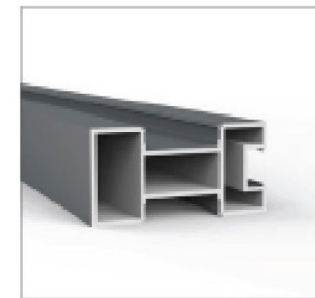
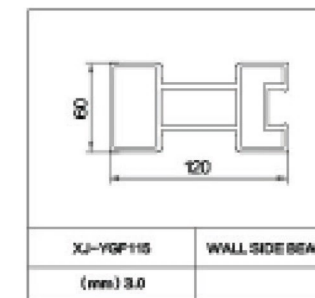
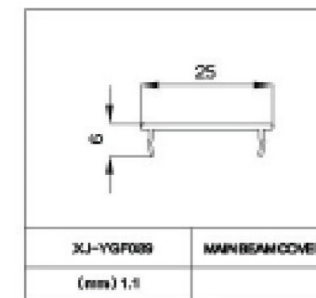
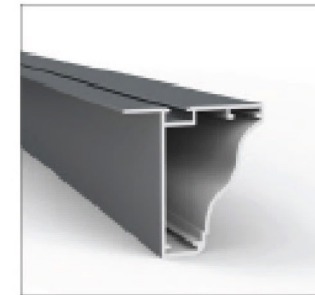
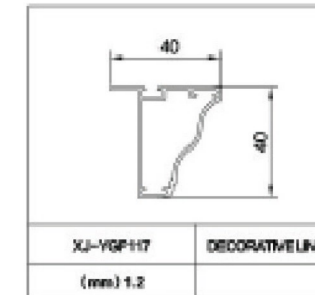
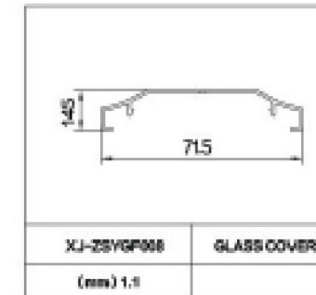
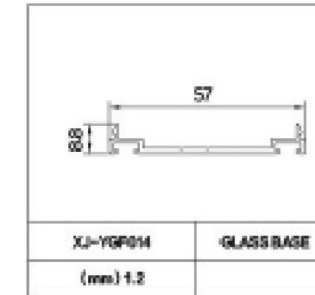
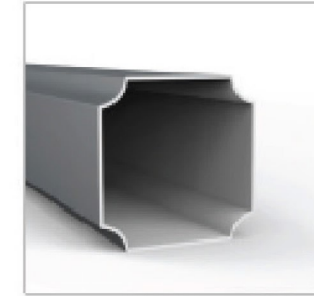
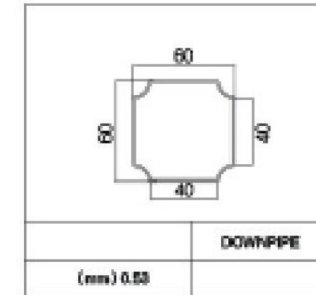
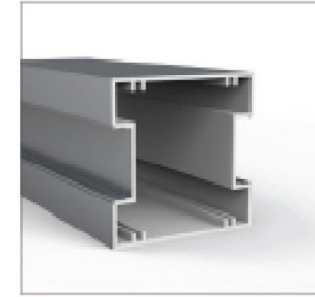
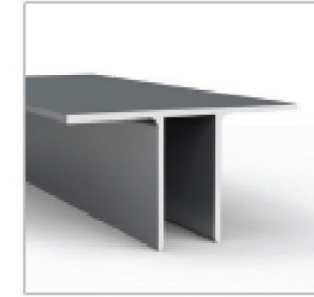
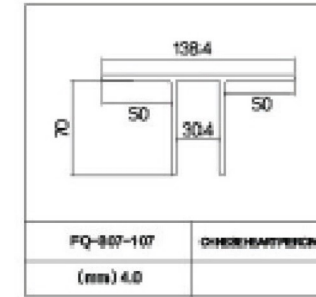

# 120 SERIES ALUMINUM SUNROOM WITH LIGHT

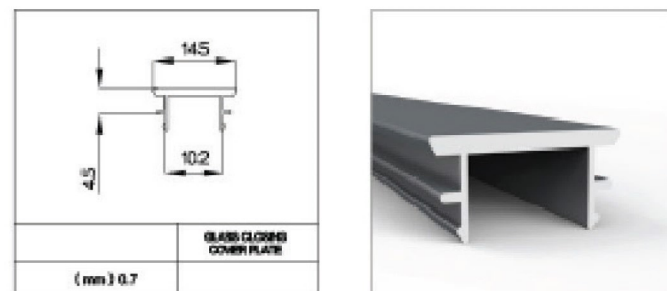
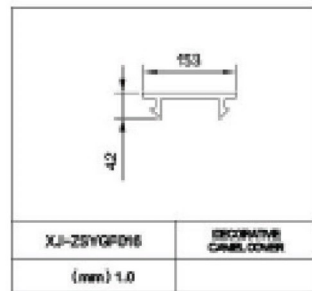
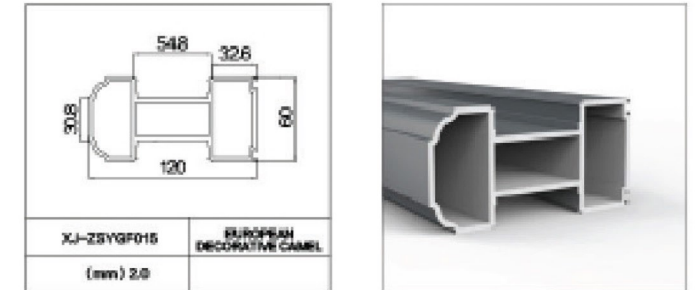
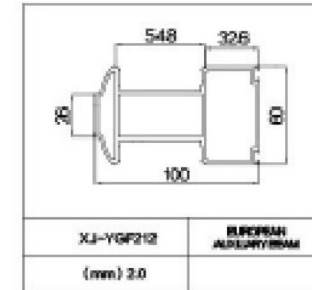
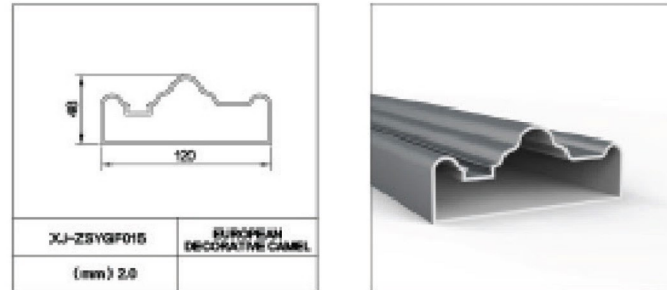
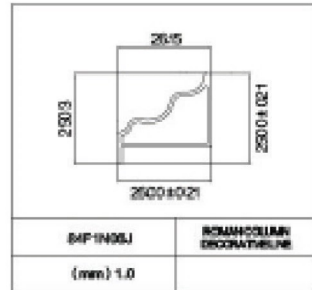
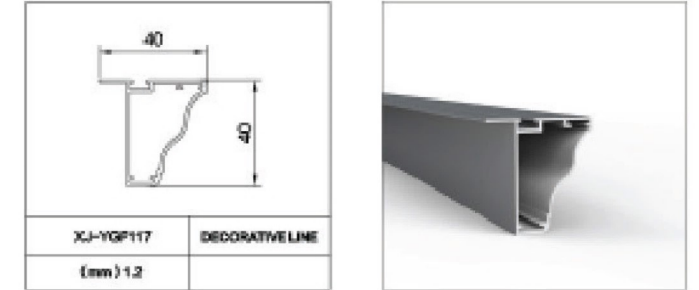
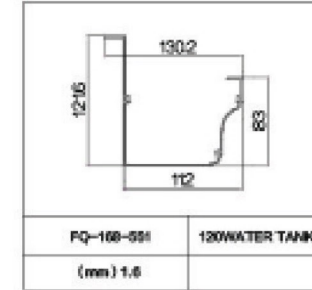
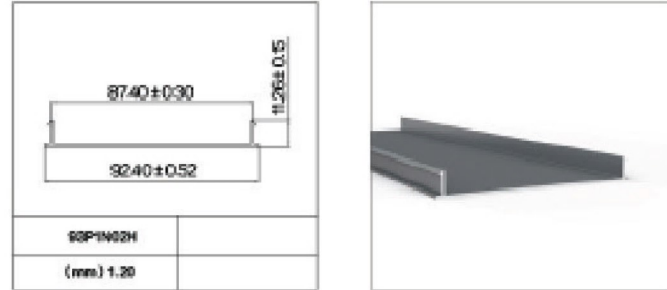
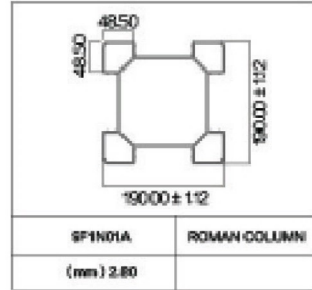
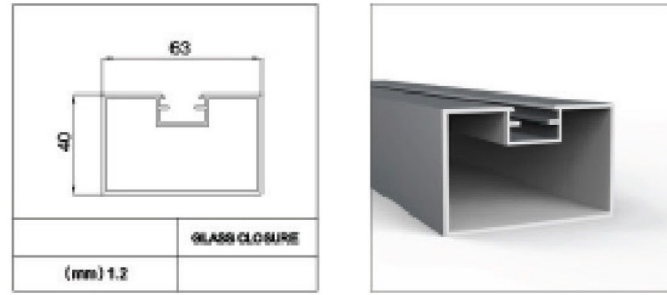

# ENGINEERING CASE





-  Patubig, Marilao, Bulacan
-  [bm.aluminum.inc@gmail.com](mailto:bm.aluminum.inc@gmail.com)
-  BM Aluminum & uPVC
-  +639677406336
-  044 248 0088